



naturekast
weatherproof cabinetry

product catalog

Design & Installation: Deck Remodelers





perfecting the art
of outdoor living.

Call: 1-844-880-6314

Showroom: 5-570 Welland Avenue
St Catharines, ON L2M 5V6

Website: www.naturekast.com





contents

DOORSTYLES.....	3
FINISHES	13
SPECIFICATIONS.....	21
GRILL BASE CABINETS	29
CERAMIC GRILL CABINETS.....	39
COOKTOP CABINETS.....	45
GALLEY WORKSTATION SUITE CABINETS.....	51
BASE CABINETS	55
WALL CABINETS	67
TALL CABINETS.....	73
INSERT CABINETS	75
SUSPENDED CABINETS.....	79
TV CABINETS.....	85
HOODS	93
PANELS, FILLERS & PILASTERS.....	97
MOLDINGS.....	121
ACCESSORIES & HARDWARE.....	131
STRUCTURAL MODIFICATIONS.....	137
SALES RESOURCES.....	139
OUTSIDE THE BOX.....	143



Design & Installation: Outdoor Kitchen Design Store



Design & Installation: SR Design Group





slab door / drawer

5%

DOOR STYLE FACTOR



CypressKast

Specifications

SPECIES AVAILABLE:  CypressKast

CONSTRUCTION: 1" thick hi-density resin Slab door, with flat back

MINIMUM/MAXIMUM DOOR SIZE: Door sizes are limited based on molds available

DRAWER FRONTS: 1" thick slab with integral edge detail

GRAIN DIRECTION, DOOR: Grain direction is vertical on doors, horizontal grain not available

GRAIN DIRECTION, DRAWER: Grain direction is horizontal on drawers, vertical grain not available

GRAIN MATCHING: Not available

FINISH OPTIONS: Slab doors are available with all CypressKast paint, stain & glaze and weathered finishes (see pages 14-17)

FINISHED BACK OF DOOR: Doors painted Super White will come with standard white backs, all other finishes will have black backs

CROSS SECTION

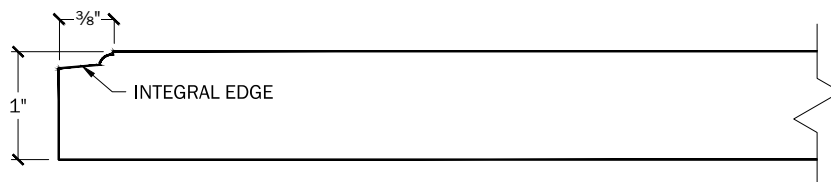

Species shown: **CypressKast**
Finish: **Espresso**

shaker door

5%

DOOR STYLE FACTOR



CypressKast



Specifications

SPECIES AVAILABLE:  CypressKast

CONSTRUCTION: 1" thick hi-density resin Shaker door, with flat back

RAIL WIDTH: 3"W only. There are simulated miter joints in the corners

MINIMUM/MAXIMUM DOOR SIZE: Door sizes are limited based on molds available

DRAWER FRONTS: 1" thick slab with integral edge detail

GRAIN DIRECTION, DOOR: Grain direction is vertical on doors, horizontal grain not available

GRAIN DIRECTION, DRAWER: Grain direction is horizontal on drawers, vertical grain not available

FINISH OPTIONS: Slab doors are available with all CypressKast paint, stain & glaze and weathered finishes (see pages 14-17)

FINISHED BACK OF DOOR: Doors painted Super White will come with standard white backs, all other finishes will have black backs

CROSS SECTION

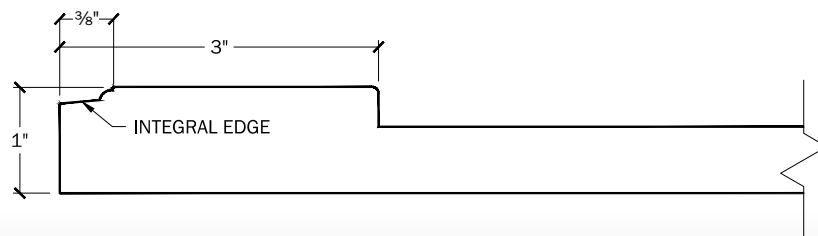

Species shown: **CypressKast**
Finish: **Super White**



louver door

10%

DOOR STYLE FACTOR



CypressKast

Specifications

SPECIES AVAILABLE:  CypressKast

CONSTRUCTION: 1" thick hi-density resin Slab door, with flat back

RAIL WIDTH: 3"W only. There are simulated mortise and tenon joints in the corners

MINIMUM/MAXIMUM DOOR SIZE: Door sizes are limited based on molds available

DRAWER FRONTS: 1" thick slab with integral edge detail

GRAIN DIRECTION, DOOR: Grain direction is vertical on doors, horizontal grain not available

GRAIN DIRECTION, DRAWER: Grain direction is horizontal on drawers, vertical grain not available

FINISH OPTIONS: Slab doors are available with all CypressKast paint, stain & glaze and weathered finishes (see pages 14-17)

FINISHED BACK OF DOOR: Doors painted Super White will come with standard white backs. All other finishes will have black backs

CROSS SECTION

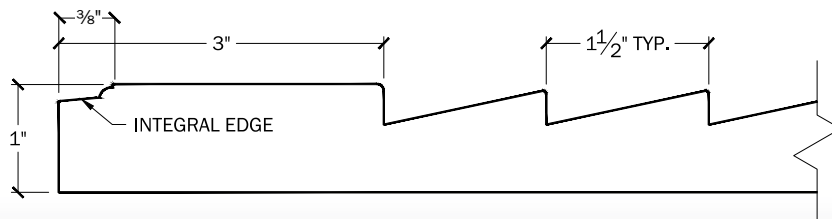

Species shown: **CypressKast**
Finish: **Weathered Graphite**

contempo door / drawer

Aluminum

30%

DOOR STYLE FACTOR

Matte Black

30%

DOOR STYLE FACTOR

Brushed Stainless

40%

DOOR STYLE FACTOR

Specifications

SPECIES AVAILABLE: **C** *CypressKast* and **T** *TeakKast*

CONSTRUCTION: 7/8" thick hi-density resin Contempo door, with flat back

STAINLESS STEEL/ALUMINUM RAIL WIDTH: Front 3/8"W and back 2". There are miter joints in the corners

MINIMUM/MAXIMUM DOOR SIZE: Doors are fabricated, so sizes are limited by our panel sizes

DRAWER FRONTS: 7/8" thick slab with anodized aluminum or brushed stainless steel edge detail

GRAIN DIRECTION, DOOR: Grain direction is vertical on door panel

GRAIN DIRECTION, DRAWER: Grain direction is horizontal on drawers, vertical grain not available

FINISH OPTIONS: Contempo doors are available with all paint, stain & glaze and weathered finishes (see pages 14-17)

FINISHED BACK OF DOOR: Doors painted Super White will come with standard white backs. All other finishes will have black backs



CypressKast



TeakKast



Species shown: **TeakKast**
Finish: **Fossil Grey**

* Contempo Door / Drawer specifications continue on to the next page.





Additional Contempo Information

CROSS SECTION

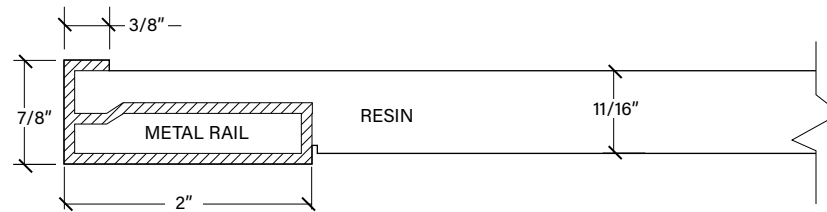

CONTEMPO GRILL FRONTS:

Contempo Grill fronts will only have the Aluminum or Stainless Steel frame on the bottom and 2 sides to make it easier to install the insulated jacket. The grill front is also attached to a 3/4" thick PVC panel, with pocket screws to facilitate simplified removal of the grill front for installation.

PVC panel to improve installation



Grill front only has stainless steel/aluminum frame on 3 sides.

CONTEMPO DRAWERS:

All Contempo drawer fronts will be attached to a 3/4" PVC panel, to improve the structural integrity of our drawers.

BUMPERS:

All Contempo doors and drawers will have bumpers drilled into key areas of the cabinet face to ensure the fronts are parallel.

TEAKKAST RESIN PART AVAILABILITY:

Please note that the selection of panels, moldings and fillers are limited in Teak resin. Refer to our online ordering system (DealerNet) for current availability.

CONTEMPO CARE GUIDE AND WARRANTY:

Please refer to our DealerNet site in the Resources section (under Forms & Policies) and download the Contempo Door care guide and Contempo Door limited warranty for the aluminum & stainless frames.

euro door / drawer

45%

DOOR STYLE FACTOR (VERTICAL)

65%

DOOR STYLE FACTOR (HORIZONTAL)



Euro



Specifications

SPECIES AVAILABLE:  *Euro*

CONSTRUCTION: ½" thick high-pressure laminate (phenolic resin) door, with ⅛" micro chamfer on an ebony colored polished edge

MINIMUM/MAXIMUM DOOR SIZE: Doors are fabricated, so sizes are limited by our panel sizes. Doors are heavy so weight limitations also apply

DRAWER FRONTS: ½" thick slab with micro chamfer edges

GRAIN DIRECTION, DOOR: Grain direction is vertical by default, but may be ordered horizontal

GRAIN DIRECTION, DRAWER: Grain direction is vertical by default, but may be ordered horizontal

FINISH OPTIONS: Available (see pages 18-19)

FINISHED BACK OF DOOR: Same finish as the front

DOOR STYLE FACTOR: Also applies to all panels and fillers

CROSS SECTION



Species shown: ***Euro (Vertical)***
Finish: **Core Ash**

*Euro Door / Drawer specifications continue on to the next page.



Additional Euro Information

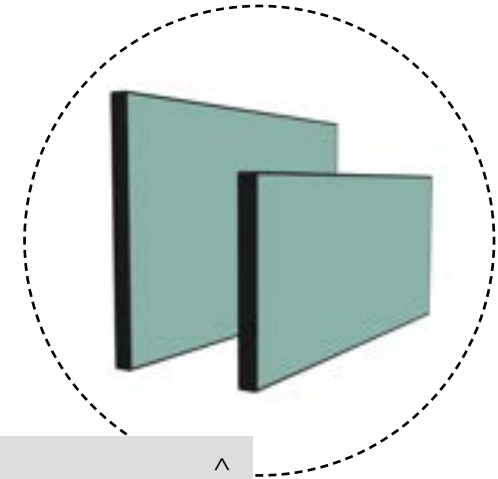

Euro panels have an ebony colored polished edge with a $\frac{1}{32}$ " micro-chamfer

EURO GRILL FRONTS:

Euro Grill fronts will need to be machined to install the insulated jacket. The grill front is attached to the cabinet with a $\frac{3}{4}$ " thick PVC panel, and has pocket screws to facilitate simplified removal of the grill front for installation.

Table saws offer the best results and Euro grill panels should be cut with the decorative side up. To further protect the surface finish, cut on top of a protective panel. Any sharp or rough edges can be removed with sandpaper or a router. Portable circular saws or jig saws (with a blade for decorative surfaces) may also be used (cut decorative side down). Masking tape can also be used to protect the surface. For more complete machining instructions, please refer to page 27 of this catalog.

EURO DRAWERS:

All Euro drawer fronts will be attached to a $\frac{3}{4}$ " PVC panel, to improve the structural integrity of our drawers.

BUMPERS:

All Euro doors and drawers will have bumpers drilled into key areas of the cabinet face to ensure the fronts are parallel.

EURO PART AVAILABILITY:

Please note that the selection of panels, moldings and fillers are limited in Euro finish. Refer to our online ordering system (DealerNet) for current availability.

metro door

0%

DOOR STYLE FACTOR



Metro



Specifications

SPECIES AVAILABLE:  *Metro*

CONSTRUCTION: $\frac{3}{4}$ " thick marine grade high-density polyethylene (HDPE) door, with $\frac{1}{32}$ " micro chamfer on a smooth edge

MINIMUM/MAXIMUM DOOR SIZE: Doors are fabricated, so sizes are limited by our panel sizes.

DRAWER FRONTS: $\frac{3}{4}$ " thick marine grade high-density polyethylene (HDPE) drawer front, with $\frac{1}{32}$ " micro chamfer on a smooth edge

GRAIN DIRECTION (IF APPLICABLE), DOOR:

Grain direction is vertical

GRAIN DIRECTION (IF APPLICABLE), DRAWER:

Grain direction is vertical

FINISH OPTIONS: Available (see page 20)

FINISHED BACK OF DOOR: Same finish as the front

CROSS SECTION

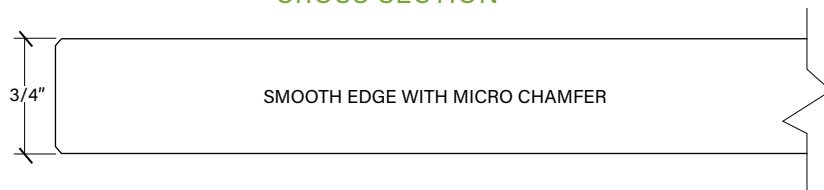

Species shown: **Metro**
Finish: **Niagara Mist**

*Metro Door / Drawer specifications continue on to the next page.



Additional Metro Information

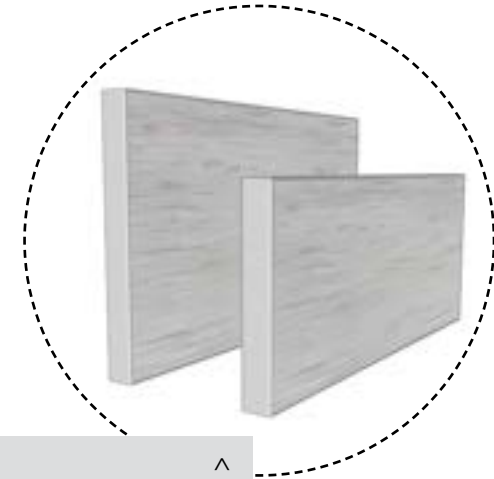

Metro panels have a smooth edge with a $\frac{1}{32}$ " micro-chamfer

METRO GRILL FRONTS:

Metro Grill fronts will need to be machined to install the insulated jacket. The grill front is attached to the cabinet with a $\frac{3}{4}$ " thick PVC panel, and has pocket screws to facilitate simplified removal of the grill front for installation. Grill fronts on wood grain Metro cabinets wider than 54" will have a discreet seam.

Standard woodworking tools offer the best results for cutting Metro grill panels. Cutting can leave a burr on one edge and this can be scraped off carefully with a craft knife. Sanding edges will produce a rough, matte edge. Finer grit sandpaper or steel wool is recommended to reduce this and introduce some sheen back. Portable circular saws or jig saws (with a blade for decorative surfaces) may also be used. For more complete machining instructions, please refer to page 28 of this catalog.

METRO DRAWERS:

All Metro drawer fronts will be attached to a $\frac{3}{4}$ " PVC panel, to improve the structural integrity of our drawers.

BUMPERS:

All Metro doors and drawers will have bumpers drilled into key areas of the cabinet face to ensure the fronts are parallel.

METRO PART AVAILABILITY:

Please note that the selection of panels, moldings and fillers are limited in Metro finish. Refer to our online ordering system (DealerNet) for current availability.



finishes



choosing your finishes



CypressKast



TeakKast

NatureKast molded doors, drawers and panels are available in three distinctive finish categories to cater to the wide tastes in home decor, namely painted, weathered or stain & glaze.

Our doors are Kast from either Cypress or Teak masters and offer the characteristics of real wood without the limitations.

cypress resin painted finish specifications

(AVAILABLE FOR SLAB, SHAKER, LOUVER & CONTEMPO DOOR STYLES)

0%

FINISH FACTOR

TECHNIQUE:

A base coat of paint is applied to the treated resin door followed by an exterior grade acrylic lacquer. This is followed by a UV inhibited top coat.

DESIGN CONSIDERATIONS:

Doors painted in Super White will come standard with a white door back, all other paint colours, stain and glaze or weathered finishes come standard with black door backs regardless of cabinet interior colour.

PRIMER CONSIDERATIONS:

Primed doors allow you the freedom to finish the doors in any colour you choose using a high-quality exterior latex paint.

- Exterior grade primer is applied to front & back of doors/drawers
- Edge banding matches PVC cabinet box colour



Super White



Midnight Tide



Olive Mist



PRIMER only



* **Disclaimer:** These colours are representations of our finishes and are not intended to be an exact match. Please ensure you make your final selection from actual samples.

cypress resin stain and glaze finish

(AVAILABLE FOR SLAB, SHAKER, LOUVER & CONTEMPO DOOR STYLES)



CypressKast

10%

FINISH FACTOR

TECHNIQUE:

A base coat of paint is applied to the treated resin door followed by an exterior grade acrylic lacquer. This is followed by glazing and then a UV inhibited top coat.

DESIGN CONSIDERATIONS:

The backs of all doors with Stain and Glaze finishes will come finished in black regardless of cabinet interior colour.



Raven Ash



Chestnut



Nutmeg



Walnut



Silver Birch



Espresso



teak resin stain and glaze finish specifications

(AVAILABLE FOR CONTEMPO, SLAB, SHAKER & LOUVER DOOR STYLES)

15%

FINISH FACTOR



CypressKast



TeakKast

TECHNIQUE:

A base coat of paint is applied to the treated resin door followed by an exterior grade acrylic lacquer. This is followed by glazing and then a UV inhibited top coat. The resin is machined and bonded to the anodized aluminum/brushed stainless steel frame.

DESIGN CONSIDERATIONS:

The backs of all doors with stain and glaze finishes will come finished in black regardless of cabinet interior colour. These five colours are all available in Teak Resin in the Contempo door style. Please note that some of the catalog items are not available in Teak resin. Refer to our online ordering system (DealerNet) for current availability. Additionally, Arctic Slate and Fossil Grey are now also available in CypressKast Louver, Shaker, Slab & Contempo door styles.



Vintage Linen



Arctic Slate



Fossil Grey



Russet Mocha



Biscotti Java



weathered cypress resin finish specifications

(AVAILABLE FOR SLAB, SHAKER, LOUVER & CONTEMPO DOOR STYLES)



CypressKast

20%

FINISH FACTOR

TECHNIQUE:

A base coat of paint is applied to the treated resin door followed by an exterior grade acrylic lacquer. This is followed by glazing and the application of artistic faux finishes and effects. Lastly, a UV inhibited top coat is applied.

DESIGN CONSIDERATIONS:

The backs of all doors with weathered finishes will come finished in black.



Weathered
Dockside



Weathered
Driftwood



Weathered
Desert Tan



Weathered
Spanish Moss



Weathered
Graphite



Weathered
Charcoal



euro finish specifications

(ONLY AVAILABLE FOR EURO DOOR STYLES)

20%

WOOD DÉCOR FINISH FACTOR



Euro

TECHNIQUE:

Layers of fibers are impregnated with thermosetting phenolic resins. Surface decorative finish layers are then applied on both sides and a transparent topcoat is added to the surface layers. This is cured to enhance weather and light protecting properties. The panels are then subject to high heat and pressure to bond the material into a non-porous, homogeneous material that is dense and perfect for outdoor surfaces like our cabinetry

DESIGN CONSIDERATIONS:

Euro doors, drawers and panels are available in Wood Décors and Pure Accents with a sleek, ebony polished edge, offering a clean, contemporary look.



Wenge



Country Wood



Slate Wood



Core Ash

10%

PURE ACCENTS FINISH FACTOR



Euro



Stone Harbour Grey

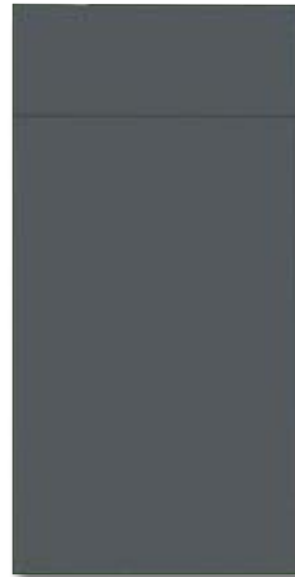

Steel Grey



Pure White



Hunter Green



Seafoam



Pacific



Ember Orange



Cobalt Blue



Midnight Blue

finishes



metro finish specifications

(ONLY AVAILABLE FOR METRO)



Metro

0%

FINISH FACTOR

TECHNIQUE:

Metro doors & panels are produced from ¾" thick high-density polyethylene (HDPE) with a textured, decorative surface on two sides and a 1/32" micro chamfer on the smooth edges. This material was developed for marine applications (UV stable, rigid and scratch resistant) making it perfect for outdoor surfaces like our cabinetry.

DESIGN CONSIDERATIONS:

Metro doors, drawers and panels are available in low sheen Wood Grain and Solid Colours with a smooth edge – offering a clean, contemporary look.



Niagara Mist



Muskoka Fog



Algonquin Fawn



Yukon Shale



Cavendish Clay



Banff Powder



Athabasca Dune



Manitoba Jay



Rocky Ridge



Kawartha Lake

* **Disclaimer:** These colours are representations of our finishes and are not intended to be an exact match. Please ensure you make your final selection from actual samples.



Picture: Koru Creative



specifications



pvc cabinet construction specifications

CUSTOMIZATION

The only customization options for NatureKast® cabinetry are indicated in our modification section. Cabinet depth modifications are available. Cabinet width and height increase or decrease modifications are NOT available.

1. CABINET BOX:

- Cabinet sides, top and floor are constructed with $\frac{3}{4}$ " thick, 100% closed cell PVC (available in white or black) using adhesive with weld-like bonding and screws

2. CABINET TOP:

- Wall and tall cabinets have a full PVC top. Base, grill base and burner base cabinets have $\frac{3}{4}$ " x $4\frac{1}{4}$ " PVC crosspieces fastened in place between the cabinet sides

3. CABINET BACK:

- All cabinets have a $\frac{3}{4}$ " thick PVC back

4. SHELVES:

- Shelves are $\frac{3}{4}$ " thick PVC. There is continuous shelf hole drilling in 32mm (~1 $\frac{1}{4}$ ") increments. Shelves in base cabinets are 16" deep. Shelves in wall and tall cabinets are full depth. The shelves are held in place with a metal pin and a removable white "V" shaped shipping retainer

5. DRAWER BOXES

- Standard drawer boxes are constructed with $\frac{1}{2}$ " PVC sides and back with a $\frac{3}{4}$ " PVC floor. Full extension soft-close stainless steel side mount slides are used

6. DOOR HINGES

- Hinges are soft-close stainless steel 110° concealed hinges with 6 way adjustment

7. FINISHED ENDS:

- Finished ends can be purchased loose or factory applied. Finished end panels are the thickness of the species panel, which adds to the overall width of a cabinet

8. EDGE TAPE:

- A closely matching PVC edge tape is applied to the front edges of the cabinet sides, top and bottom edges

9. TOE KICK:

- All base & tall cabinets are constructed on adjustable leg levelers secured behind a 2 $\frac{1}{4}$ "H PVC skirting



cabinet standards



GENERAL SPECIFICATIONS:

NatureKast® manufactures our cabinet boxes using ¾" PVC. This PVC MUST be 100% covered by our doors and panels (when placed in direct sunlight) to protect the PVC parts from warping from the high temperatures of direct sunlight, as well as colour bleaching on the black PVC in direct sunlight. Failure to cover our PVC components will not be covered by our warranty. The tops of PVC cabinet boxes must be covered from direct sunlight before counter tops are installed.

CABINET SIZES:

Available in sizes listed only. To increase the depth of a cabinet, modification charges will apply. See modification section for up-charges.

DIMENSIONAL TOLERANCES:

Both black and white cabinet constructions are manufactured using PVC components. This PVC is rigid and is not subjected to the same expansion and contraction issues as wood products, therefore the tolerance for both black and white PVC is $\pm \frac{1}{16}$ ". All cabinet construction types will have a $\pm \frac{1}{32}$ " height tolerance. All cabinetry will have the floors and cabinet tops flush (in the vertical direction) with the cabinet sides. The floors will be flush with the cabinet sides, or inset up to a maximum of the thickness of any applied edge tape.

MINIMUM CABINET WIDTH: With doors: 9"W based on the minimum width of available door styles. With drawers: 12"W.

MAXIMUM CABINET WIDTH: To be warranted, the maximum width of a specific cabinet type is the width listed as the largest available.

MINIMUM HEIGHT: With doors: 18"H.

MAXIMUM HEIGHT: 90"H (plus adjustable leg levelers). This is a tall cabinet with 3 - 30"H doors.

STANDARD CABINET DEPTHS (DEFAULTS):

Wall cabinets: 12"D | Base cabinets: 24"D | Grill base cabinets: 28"D | Burner base cabinets: 24"D | Wall depth tall cabinets: 12"D | Base depth tall cabinets: 24"D

STANDARD CABINET HEIGHTS (PLUS ADJUSTABLE LEG LEVELERS):

Grill cabinets: 30"H | Base cabinets: 30"H | Tall cabinets: 90"H

MINIMUM DEPTH: With hinges: 5"D with cabinet back, 4"D with no back.

MAXIMUM DEPTH: 32"D. When the depth is increased for cabinets with drawers and/or roll out drawers, the drawer box depth remains 550mm (approx. 22") regardless of cabinet depth.

FINISHED ENDS:

NatureKast® provides finished ends as an applied panel, subject to additional up-charges. These panels will be applied during manufacturing and will add ¾" to the width of the cabinet per finished side for resin and Metro panels and ½" per finished side for Euro panels.

TOE KICK:

NatureKast® provides PVC leg levelers that are adjustable from 4"H to 7 ½"H. We also offer door matching toe kick planks in heights of 5", 6" or 7"H (species dependent) and species-specific lengths which can be cut on site to level against concrete floors and decks.

CABINET EDGES:

Cabinet edges (side, top, bottom and any fixed floors) are edged with a close matching PVC edge tape. Shelves have a sealed edge, which will match the interior of the cabinet – black or white.

GRILL CABINETS: The front and back stretchers of grill cabinets wider than 30" will be reinforced with 2 aluminum L-profiles for additional strength.



door & drawer standards and pricing explanation

Door & Drawer Standards

REVEALS:

Our door and drawer sizes are approximately $\frac{1}{8}$ " less in width and in height, but these can vary depending on the tolerances listed above. We position the fronts so that there is a $\frac{1}{8}$ " reveal at the top of the cabinet, $\frac{1}{16}$ " reveal on each side and zero reveal on the bottom of each cabinet.

DIMENSIONAL TOLERANCES:

Resin doors

Our doors and drawers are constructed using durable high density resin. Each door or drawer is created using a specific size mold. The width, height and thickness of the fronts can vary (although this is not common) from door to door and drawer to drawer up to $\frac{3}{16}$ ". This is not a warranty issue.

Euro doors

Our Euro doors and drawers are constructed using durable high pressure laminate (HPL). Each door or drawer is cut from a large sheet, and an ebony coloured edge profile is left polished and has a $\frac{1}{32}$ " micro chamfer.

Metro doors

Our Metro doors and drawers are constructed using rigid marine grade high-density polyethylene (HDPE). Each door or drawer is cut from a sheet and finished with a smooth edge, colour-matched core and a $\frac{1}{32}$ " micro chamfer.

Drawer Box Standards

GENERAL CONSTRUCTION:

Our drawer boxes are constructed using $\frac{1}{2}$ " PVC for the sides, front and back with $\frac{3}{4}$ " thick bottoms. The top edges of the drawer boxes are eased and sealed. We use 22"D, 35kg (77lb) capacity full extension soft-close stainless steel drawer tracks for all standard drawers. There are 2 drawer box heights, 4"H for top drawers and 8"H for deep drawers.

SLIDE OUT TRAYS:

Our slide out trays are constructed using $\frac{1}{2}$ " PVC for the sides and back with $\frac{3}{4}$ " thick scooped front and bottoms. The top edges are eased and sealed. We use 22"D, 35kg (77lb) capacity full extension soft-close stainless steel drawer tracks. Slide out trays are either 4"H or 8"H.

Pricing

PRICING EXPLANATION:

The prices listed in this catalog are subject to door style up-charges and finish up-charges in the following manner:

- Cabinets with doors will have the door style and finish up-charge applied
- Cabinets without doors will only have the finish up-charge applied
- Finished items that are not doors such as fillers, pilasters, moldings etc., will only have the finish up-charge applied, except for Euro panels which always also have the door factor due to finishing required
- Unfinished items such as waste bins, tray dividers, slide-out trays etc., will have neither the door style nor the finish up-charge applied

While great care has been taken to ensure the accuracy of this Catalog, NatureKast® does not guarantee the product prices, specifications and or graphics as they may contain technical inaccuracies or typographical errors. NatureKast® also reserves the right at any time to correct errors and adjust prices to account for circumstances beyond our control.

general design considerations



Designing an outdoor kitchen is very different to designing an indoor kitchen. Priorities change when planning storage areas and placement of appliances. There are more safety requirements to consider with the high BTU grills and burners. Ventilation can be critical to the design so as to prevent outdoor gatherings from being smoked out. The following is a list of points to design a safe, efficient and attractive outdoor kitchen:

- NatureKast® and real wood kitchens require the grill to have an insulation jacket (zero clearance kit) and most grill manufacturers provide them. If you build a non-combustible liner out of Dura-rock or another non-combustible material, it will void your warranty with the manufacturer
- From our experience, the cut-out specifications for insulation (zero clearance) jackets can require the grill base to be anywhere from 6" to 12" wider than the grill. **It is absolutely essential to consult your grill manufacturers' specifications** when selecting an **appropriate grill cabinet size** to properly house the grill and insulation jacket
- Grills normally require a minimum of 3" behind the grill to open the lid against a wall. The majority of grills require a total of 27" depth. NatureKast® offers posts and pilasters to finish the extended sides of the grill when bumped out to 28". If you are using a panel to cover the exposed sides, allow for ¾" for each panel
- Keep a minimum of 6" between side burners and grills. Design side burners opposite the rotisserie motor on the grill
- Keep fryers a minimum of 12" from any open flame burners or grills. Flames can ignite fryers in high wind situations
- If the outdoor kitchen is under cover and does not have good cross ventilation, an exhaust hood will be required to prevent smoke from collecting in the kitchen and entertainment areas. Hoods comprise three main parts: the liner, the hood insert and the blower. The liner is a stainless steel ceiling with a cut out into the bottom hood which should be at least 4" deep to trap the smoke to be dispersed. The hood insert is the part containing the filters and light and is connected to the blower. The blower, which should be a minimum of 1000 CFM, can be located on the insert or can be used in a remote location that has access, such as an attic, exterior wall or on the roof (to keep the noise of the blower out of the cooking area). Remote switches are available for blower and lights; to prevent reaching over a hot grill to turn on lights or blower
- Hoods are normally installed 36" above the cooking surface. This distance is required for hoods built with combustible materials; however, consult your local building codes for specific rules
- A higher BTU is required when designing a burner for seafood boils, or for deep frying. These burners are wider than the standard side burners and are called power burners due to their high BTU rating. Tall pots are used for this type of cooking so a lower cabinet allows easier access to the top of the pot. NatureKast® offers a 30" wide power burner base that is only 28 ½" tall. If the power burner is to remain at the same height, NatureKast® offers two 24" wide burner bases that will work with most power burners. The granite, or any non-combustible materials, must be used on either side that is lowered. Check specifications on burners to determine the distance to the non-combustible sides and back when lowering a burner
- Ceramic grills are becoming more and more common and can be built into the cabinets. The most common ceramic grills require a full 10" clearance (double check this dimension with the specific grill size) behind the grill for the ceramic dome lid to open. With 22" being the most common ceramic grill width, the cabinet will need to be approximately 34" deep (again double check this dimension with the specific grill size). Determine if this space allows this depth in your plan. Ceramic grills can be built into a lowered cabinet for the cooking grate to be a comfortable height. Use a minimum of 27" width for dropping a ceramic grill in the design. Adjoining 24" deep cabinets can be pulled to 34" to eliminate the deep step out of the ceramic grill cabinet. If there is not enough space to pull the cabinets out, NatureKast® has created the first bowed front ceramic grill cabinet that allows the drop-down ceramic grill cabinet to be a standard 24" deep to match adjoining bases and bows out to 34". This bowed unit allows for proper depth and height of the ceramic grill. The bowed cabinet also adds a unique design element to the plan. A non-combustible counter is required on the lower bowed base platform
- When designing islands or peninsulas that are not attached to walls, it is recommended that you order 7" x 96" PVC planks to make a toe kick assembly. This replaces the adjustable leg levelers and allows installers to secure the toe kick frame to the floor. Another option is to set the island or peninsula using the adjustable leg levelers. PVC bracing can be added to secure cabinetry to the floor. Bracing can be trimmed-to-fit and glued to the bottom of the cabinet. This is not necessary when cabinets are secured to a wall



installation

Working with NatureKast® cabinetry is something many cabinet installers may not have experienced. The following information provides guidelines when working with PVC, resin, phenolics and HDPE:

GENERAL INSTALLATION GUIDELINES

- Machining should only be done by a machining or construction professional using proper equipment
- Use stainless steel screws and washers for installation and hardware
- Grill panels are loosely attached, so they may be removed in order to trim and fit to the grill. Reattach the trimmed grill panel to the PVC cleats and stretcher using the supplied pocket screws

PVC BOXES AND PARTS

- Bonds with clear PVC cement to create a strong bond in minutes
- Very easy on tools. Saws and machines similar to MDF with smooth, non-splintered, chip free cuts
- Cleans with soap and water. Use denatured alcohol for greasy spots
- Use PVC planks and panels for blocking void corners for counter tops, L-shape bracing between adjustable leg levelers and for miscellaneous blocking
- All cabinet backs are 3/4" PVC. No nailers are required. Screws will hold anywhere on the back panel when attaching to walls or other fixed structures.
- Washers are recommended for wall cabinets and applications that don't require counter-sinking of the screw head
- Bases come with adjustable leg levelers, making installation easy on sloped floors. These are installed at NatureKast® so no measuring is required for leg placement
- For convenience, use our PVC toe kick skirting surrounding the leg levelers to attach the toe-kick below the cabinets

HI-DENSITY RESIN

- Use Gorilla glue to adhere resin to resin
- Use polyurethane adhesives to adhere resin to PVC. We recommend NP1 or PL Premium for this purpose
- Resin wood and stone products clean with denatured alcohol
- Touch-up for scratches or small chips is the same procedure as touch ups for real wood products. NatureKast® offers touch up kits for all finishes
- Resin cuts much easier than wood and is easy on tools. Blades last much longer due to this resin material
- Resin fillers come attached to PVC backers. Attach fillers with PVC backer flush with front of cabinet box. Fillers are very easy to scribe to non-plumb walls
- Hardware bolts need to go through resin wood drawer fronts and PVC drawer box to be secure. Use stainless steel bolts and washers

HIGH-PRESSURE LAMINATE (EURO)

- Working with HPL is comparable to machining high quality hardwood. Carbide tipped tools (for metal working) are recommended
- Use outdoor panel adhesives to adhere Euro doors, drawers and panels to PVC. More info is on the next page
- Do not use abrasive cleaning agents. If required, Euro can be cleaned with citrus-based household cleaners

HIGH-DENSITY POLYETHYLENE (METRO)

- HDPE machines similarly to MDF. Use regular woodworking tools for best results
- Mechanical fasteners are recommended as Metro panels will not bond with regular construction adhesive
- Specific HDPE adhesives are available
- HDPE can be cleaned using a mild detergent and dried with a soft towel
- Do not paint or stain HDPE - the surface resists adhesion to most regular paint and adhesives

Please refer to our DealerNet website (www.naturekastorders.com) in the 'Resources' section (under Forms & Policies) to download the Contempo Care and Use guide and the Euro Machining, Installation and Care guide

working with our Euro HPL panels



This guide is intended to provide some more general information as to the intricacies of working with our Euro doors and panels.

IMPORTANT NOTE:

- While Euro panels will withstand the harshest weather conditions, the material **can expand and contract very slightly**, depending on humidity. This variance is only **0.021" per linear foot** (measured outwards from a central point in the panel). Please factor this into the design when installing Euro cabinetry. There is no expansion in thickness
- Please factor this expansion when producing butt joints with Euro panels. A 1/8" gap is recommended between larger panels
- The surface of Euro panels has been cured to produce a ultra tough surface, which will dull kitchen knives if used as a cutting surface. While this fact remains, Euro panels should not be stored directly on top of other Euro panels as the faces on these tough surfaces can scuff each other, similar to diamonds cutting other diamonds. When handling, panels should be lifted where possible rather than sliding on the decorative surface.

SAWING

- Euro panels can be cut on stationary circular saws, portable circular saws or jig saws using carbide tipped blades
- Cut at 23 - 72 ft/min. Cutting too fast or too slow can result in the surface colour changing due to excessive heat. The discoloured surface can be routed/sanded off, but cutting at the correct speed can prevent this
- Entering tooth should be at the decorative side of the Euro panel. Circular saw blades should be set at a height of at least double the panel thickness.

FINISHING

- Cut edges are dangerously sharp and need to be eased. We recommend routing the edges or breaking the edge with sand paper.

DRILLING

- Use a carbide-tipped HSS-drill with a top angle of 60-80°.

FIXING

- Stainless steel screws offer the most secure way of attaching Euro panel/fillers/overlay doors to our cabinetry, but allow for panel expansion
- Carefully drill a pilot hole first. Stainless steel self tapping screws are a good option as Euro panels produce a fine thread and can be tapped.

BONDING

- Do not try to bond in rain or high humidity. Both surfaces should be clean and dry
- For additional adhesion, the back of the panel may be roughened with sandpaper to ensure the adhesive bonds well to the surface
- The Euro panel must be dry, clean and free from dust and grease
- Clean the surface of the Euro panel well with denatured rubbing alcohol. Wipe off with paper tissue or a clean, lint-free cloth. Allow alcohol to dry fully
- Once the Euro surface is prepared, apply a thin layer of adhesive across the surface of the panel and clamp for up to 24 hours. We recommend Tweha PanelMate adhesive, SikaTack panel adhesive or Simson PanelTack. Adhesive will skin in about 10-15 minutes, but it is important to clamp the piece until the adhesive has properly cured to prevent the panel from shifting/sagging due to the heavy weight of the panels
- Apply between +5°C and +30°C
- Adhesives can typically operate between -40°C (-40°F) to 90°C (194°F)
- For certain applications requiring immediate fixing, Tweha tape or Sika Fixing Tape could be applied between lines of adhesive, but this will result in a 1/8" standoff between the surface substrate and the Euro panels



working with our Metro HDPE panels

Below you will find general guidelines for working with our Metro doors and panels.

GENERAL CONSIDERATIONS:

- Do not paint or stain HDPE - the surface has very low surface energy and resists adhesion to most regular paints and adhesives
- HDPE can be cleaned using a mild detergent and dried with a soft towel or chamois
- While HDPE is resistant to harsh chemicals, most stains can be removed simply with regular household cleaning products
- A soft bristle brush can be used for hard-to-clean spots

SAWING

- Cutting a test piece prior to production is recommended
- Standard woodworking tools offer the best results for cutting Metro panels
- Carbide tipped tools are recommended
- CNC routers can achieve a very smooth edge, but table saws, radial arm saws, panel saw, band saws or jig saws (with a blade for decorative surfaces) may also be used
- Tools should be sharp to ensure adequate chip removal, which helps eliminate heat build-up
- Dull tools or an improper feed rate can lead to rough edges and heat build-up to the point where the chips start to melt and refuse
- Cutting can leave a burr on one edge and this can be scraped off carefully with a craft/box knife

FINISHING

- After cutting, the edges should be broken with a micro chamfer as cut material can be sharp. Sanding Metro edges will produce a rough, matte edge. Finer grit sandpaper or steel wool is recommended to reduce this and introduce some sheen back
- An iron and parchment paper can help get more sheen back on the sanded edges

DRILLING

- Use a carbide-tipped HSS-drill with a top angle of 90-110°, together with a peck drilling technique to reduce chip wrap on the drill bit

FIXING

- Stainless steel screws or nails/staples may be used to fasten HDPE material: pre-drilling is typically unnecessary
- Threaded inserts may also be used, but the holes should preferably be drilled 1" from the edge of the material

BONDING

- HDPE is difficult to bond due to the low surface energy (slippery surface). For this reason, HDPE will NOT bond with regular construction adhesive
- When bonding HDPE to PVC or HDPE to HDPE, we recommend 3M's DP-8010NS or B-45 (from Reltec llc). Both are two-part adhesives, which have been specifically formulated for HDPE and bond well to PVC and other materials without requiring surface treatment
- HDPE may also be welded to HDPE using a variety of techniques like hot gas welding, notch welding, bend welding or extrusion welding – but these techniques require special equipment and expertise

Please refer to our DealerNet website (www.naturekastorders.com) in the 'Resources' section (under Literature) to download the Metro Installation Guidelines document



Design & Installation: Good Life New England



grill base cabinets



grill base specifications

 NatureKast® grill and side burner bases range in size options from 15" to 90" wide and are constructed from ¾" black or white PVC panels that are 100% closed cell, making them completely weatherproof.

- These grill bases should be ordered according to the size of your grill and insulation jacket. If we do not offer the exact size, please choose the next size up. Our grill bases come standard at 28" deep for proper distancing, allowing lids to open unhindered. Our burner bases are 24" deep
- Insulated jackets are required with our cabinetry. Note: Basic rule of thumb is to add 6" to the width of the grill in your design to allow for the jacket. Some manufacturers (such as Lynx) require the use of oversized jackets with their grills. Please be sure of the manufacturer's specified cut-out size before ordering your cabinet
- Cabinet gables have grill front mounting cleats (¾" thick) to allow for easy installation of the grill fronts. Please factor this into your choice of cabinet size
- The **available cut-out width** for the insulated jacket is as follows: **cabinet width - 1 ½"** (for the gables) - **1 ½"** (for the grill front mounting cleats)
- The lower stretchers of grill cabinets with doors 21" or wider will be reinforced with 2 aluminum L-profiles for additional strength
- All grill base cabinets have a second upper stretcher to support grills. These can be removed, if extra depth is required
- Grill panels will match door thickness and are easily cut on site to fit each grill. All grill bases come with solid grill panels
- In most cases a standard **propane tank** can be tilted and inserted into our standard grill or we also offer propane pull-outs with larger door
- Standard grill cabinets are 30"H plus an adjustable leg leveler (standard toe kick is 4 ½"H)
- Bottom and side edges have door matching integral edge details.
- The **grill fronts for Metro wood grain grill cabinets wider than 54" will have a seam/seams**

Front panels are shipped fully intact and are to be cut on site to custom fit each grill.



Ventilation screens are installed into the bottom of all grill base and burner base cabinets in order to prevent potential gas build-up within the cabinets.

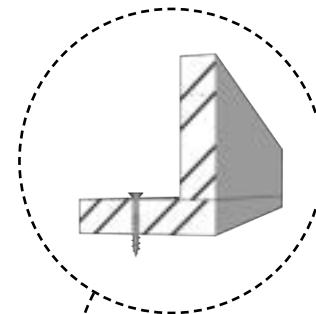

PVC risers are trimmed on site to provide the proper grill height. The stretcher and riser system allows air flow for proper ventilation. **Place risers near to/above the partitions**



Our innovative grill bases allow for flexibility, and we have a vast array of sizes to fit any burner or grill.

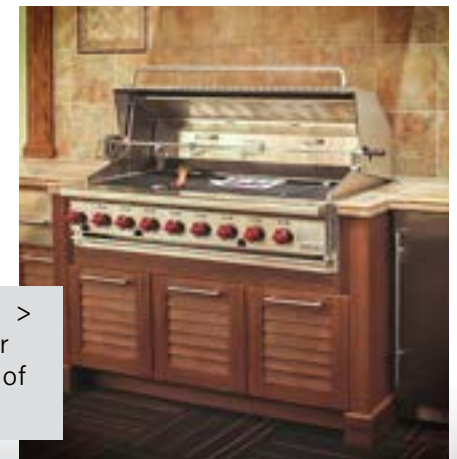

standard grill base cabinets



2 Doors



C T E M

item-code

GB2728-2

GB3028-2

GB3628-2

GB3928-2

GB4228-2

Design Considerations:

- Cabinet is 28" deep
- Front panel is 11 7/8"H
- Panel can be cut on site to fit individual grills
- Doors are 17 7/8"H

Partition:

- Cabinets 36"W and wider will have a centered interior mini partition between the butt doors

2 Doors with
XL Grill Front



*XL has extended front panel for grill with larger control panel

C T E M

item-code

*GBXL3628-2

*GBXL4228-2

Design Considerations:

- Cabinet is 28" deep
- Front panel is 17 7/8"H for extra large control panels
- Panel can be cut on site to fit individual grills
- Doors are 11 7/8"H

Partition:

- Cabinets will have a centered interior mini partition between the butt doors

3 Doors



C T E M

item-code

GB4528-3

GB4828-3

GB5428-3

GB6328-3

Design Considerations:

- Cabinet is 28" deep
- Front panel is 11 7/8"H
- Panel can be cut on site to fit individual grills
- Doors are 17 7/8"H

Partition:

- Cabinets will have a partition separating the left door and butt doors
- 54"W & 63"W cabinets will have a mini partition between the butt doors

4 Doors



C T E M

item-code

GB6028-4

GB7228-4

GB8428-4

Design Considerations:

- Cabinet is 28" deep
- Front panel is 11 7/8"H
- Panel can be cut on site to fit individual grills
- Doors are 17 7/8"H

Partition:

- Cabinets will have a centered interior partition separating the 2 sets of butt doors
- 72"W & 84"W cabinets will have a mini partition between the butt doors

Species available: **C** CypressKast **T** TeakKast **E** Euro **M** Metro

* Note: These values (*) are not subject to Door Style or Finish upcharges.



grill bases with drawers

2 Drawers



C T E M

item-code

GB2D3628

GB2D4228

Design Considerations:

- Cabinet is 28" deep
- Front panel is 11 7/8"H
- Panel can be cut on site to fit individual grills
- Drawers are 17 7/8"H

Partition:

- There is a partition separating the drawers

2 Drawers with
XL Grill Front



*XL has extended front panel for grill with larger control panel

C T E M

item-code

*GB2DXL3628-2

*GB2DXL4228-2

Design Considerations:

- Cabinet is 28" deep
- Front panel is 17 7/8"H for extra large control panels
- Panel can be cut on site to fit individual grills
- Drawers are 11 7/8"H

Partition:

- There is a partition separating the drawers

2 Left Drawers & 1 Door



C T E M

item-code

GB2D1D3628L

GB2D1D4228L

Design Considerations:

- Cabinet is 28" deep
- Front panel is 11 7/8"H
- Panel can be cut on site to fit individual grills
- Door is 17 7/8"H
- Upper drawer is 5 7/8"H
- Lower drawer is 11 7/8"H

Partition:

- There is a partition separating the door and drawers

2 Right Drawers & 1 Door



C T E M

item-code

GB2D1D3628R

GB2D1D4228R

Design Considerations:

- Cabinet is 28" deep
- Front panel is 11 7/8"H
- Panel can be cut on site to fit individual grills
- Door is 17 7/8"H
- Upper drawer is 5 7/8"H
- Lower drawer is 11 7/8"H

Partition:

- There is a partition separating the door and drawers

2 Left Drawers & 2 Doors



CTEM

item-code

GB2DD4528L

GB2DD5428L

GB2DD6328L

Design Considerations:

- Cabinet is 28" deep
- Front panel is 11 7/8"H
- Panel can be cut on site to fit individual grills
- Doors are 17 7/8"H
- Upper drawer is 5 7/8"H
- Lower drawer is 11 7/8"H

Partition:

- There is a partition separating the drawers and butt doors
- 54"W & 63"W cabinets will also have a mini partition between the butt doors

2 Center Drawers & 2 Doors



CTEM

item-code

GB2DC4528

GB2DC5428

GB2DC6328

Design Considerations:

- Cabinet is 28" deep
- Front panel is 11 7/8"H
- Panel can be cut on site to fit individual grills
- Doors are 17 7/8"H
- Upper drawer is 5 7/8"H
- Lower drawer is 11 7/8"H

Partition:

- There are two partitions separating the doors and drawers

2 Right Drawers & 2 Doors



CTEM

item-code

GB2DD4528R

GB2DD5428R

GB2DD6328R

Design Considerations:

- Cabinet is 28" deep
- Front panel is 11 7/8"H
- Panel can be cut on site to fit individual grills
- Doors are 17 7/8"H
- Upper drawer is 5 7/8"H
- Lower drawer is 11 7/8"H

Partition:

- There is a partition separating the drawers and butt doors
- 54"W & 63"W cabinets will also have a mini partition between the butt doors



4 Drawers



C T E M

item-code

GB4D3628

GB4D4228

GB4D4828

GB4D5428

GB4D6028

Design Considerations:

- Cabinet is 28" deep
- Front panel is 11 7/8"H
- Panel can be cut on site to fit individual grills
- Upper drawers are 5 7/8"H
- Lower drawers are 11 7/8"H

Partition:

- There is a partition separating the two sets of drawers

4 Left Drawers & 1 Door



C T E M

item-code

GB4DD4528L

GB4DD5428L

GB4DD6328L

Design Considerations:

- Cabinet is 28" deep
- Front panel is 11 7/8"H
- Panel can be cut on site to fit individual grills
- Door is 17 7/8"H
- Upper drawer is 5 7/8"H
- Lower drawer is 11 7/8"H

Partition:

- There is a partition separating the sets of drawers and the door & drawers

4 Right Drawers & 1 Door



C T E M

item-code

GB4DD4528R

GB4DD5428R

GB4DD6328R

Design Considerations:

- Cabinet is 28" deep
- Front panel is 11 7/8"H
- Panel can be cut on site to fit individual grills
- Door is 17 7/8"H
- Upper drawer is 5 7/8"H
- Lower drawer is 11 7/8"H

Partition:

- There is a partition separating the sets of drawers and the door & drawers



4 Equal 9"H Drawers



CTEM

item-code

GB4EQDR60

Design Considerations:

- The 60" wide cabinet has four drawers
- Cabinet is 28" deep
- Front panel is 11 7/8"H
- Panel can be cut on site to fit individual grills
- Drawers are 9"H
- The middle stretcher is reinforced with 2 aluminum L-profiles for additional structural strength

Partition:

- There is a full-depth vertical partition between the drawers

6 Equal 9"H Drawers



CTEM

item-code

GB6EQDR90

Design Considerations:

- The 90" wide cabinet has six drawers
- Cabinet is 28" deep
- Front panel is 11 7/8"H
- Panel can be cut on site to fit individual grills
- The middle stretcher is reinforced with 2 aluminum L-profiles for additional structural strength
- Drawers are 9"H

Partition:

- There are full-depth vertical partitions between the drawers



grill base with propane pull out

Left Propane Pull Out



CTEM

item-code

GBPPO3628L

GBPPO4228L

Right Propane Pull Out



CTEM

item-code

GBPPO3628R

GBPPO4228R

Design Considerations:

- Cabinets are 28" deep
- **Front grill panel is reduced in height to 9 7/8" to allow for the taller doors that are required for the propane tank pull out**
- Check the height specifications on the grill insulation jacket to make sure it will fit
- Doors are 19 7/8"H (19 7/8"H clearance needed for the propane tank)
- Panel can be cut on site to fit individual grills
- Propane slide out is a 3/4" thick cabinet line match PVC tray, with a routed hole capable of accepting bottom flange of standard 20 lbs BBQ propane tank. Standard propane tanks are ±17 3/4"H
- Please check grills specs for gas outlet side, in order to determine the best side for the pull out

Partition:

- There is a partition separating the doors for all cabinet sizes

burner base cabinets

1 Drawer Burner Base



CTEM

item-code

BB1D15

BB1D18

BB1D21

BB1D24

Design Considerations:

- Cabinets are 24" deep
- Front panel is 11 7/8"H
- Panel can be cut on site to fit individual grills
- Drawer front is 17 7/8"H

2 Drawer Burner Base



CTEM

item-code

BB2D15

BB2D18

BB2D21

BB2D24

BB2D27

BB2D30

Design Considerations:

- Cabinets are 24" deep
- Front panel is 11 7/8"H
- Panel can be cut on site to fit individual grills
- Upper drawer front is 5 7/8"H
- Lower drawer front is 11 7/8"H



1 Door Burner Base



CTEM

item-code

BB15(L,R)

BB18(L,R)

BB21(L,R)

Design Considerations:

- Cabinets are 24" deep
- Front panel is 11 7/8"H
- Panel can be cut on site to fit individual grills
- Door is 17 7/8"H

Burner Base Drop Down



* This cabinet is 24"H plus toe-kick

CTEM

item-code

BBDD15

BBDD18

BBDD24

BBDD27

BBDD30

Design Considerations:

- Cabinets are 24" deep
- Front panel is 11 7/8"H
- Panel can be cut on site to fit individual grills
- Drawer front is 11 7/8"H

warming drawer

Warming Drawer Grill Base



CTEM

item-code

GBWD3628

GBWD4228

GBWD4528

Design Considerations:

- Cabinet is 28" deep
- Front panel is 11 7/8"H
- Panel can be cut on site to fit individual grill and warming drawer
- Lower front is 17 7/8"H
- Comes with 3 risers/ stretchers for grill and 3 for warming base to properly position appliances
- Partition ships loose

grill accessories

Organizer Pull Out



CTEM

item-code

GBOP0924(L,R)

Design Considerations:

- Cabinet is 24" deep
- Comes with 7 hooks included
- Polyethylene structure with full access stainless steel slides
- 100lb weight capacity
- Organizer unit is only available in white



Design & Installation: Four Seasons Outdoor Kitchen & Bar Design



ceramic grill
cabinets



ceramic grill cabinet specifications

- NatureKast® has introduced the first bowed front ceramic grill that allows your base cabinetry to be the standard 24" depth and projects the grill out to allow clearance.
- Normally, ceramic grill cabinets are 30" - 32" tall (including counter tops) for comfortable grilling height. The problem is your counter top height is then too low for cutting and preparing food. With the new suspended ceramic grill by NatureKast® the counter top can be a standard kitchen height and the grill is adjusted to the perfect height
- Create your own look and style using our suspended ceramic grill cabinet between panels, posts, or cabinets
- When installing the countertop, please consult the ceramic grill manufacturer's air clearance gap required to countertop. Typically please allow 1 - 2" of air space between the ceramic grill and the countertop to prevent heat transfer
- Ceramic grills can require up to 10" clearance for the ceramic dome lid to open when the cabinet is against the wall
- **All ceramic grill cabinets will require a non-combustible lower deck for the grill to sit on.** We recommend the same material as the counter top
- Ceramic grills are available in a variety of sizes. Please specify the gap required between the lower deck and the top rail as per the ceramic grill manufacturer's specifications.

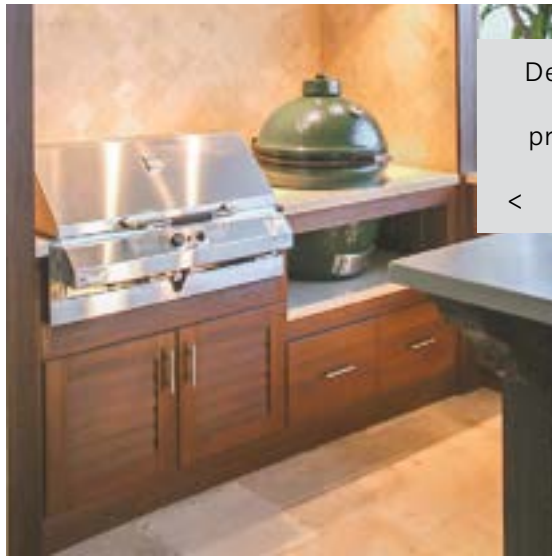

Deep storage drawers on cabinets like our CGCD36 grill cabinet provide a smart solution for quick and easy storage.

<



Using the suspended ceramic grill cabinet, the height of the cooking surface can be set to fit the cook, while keeping preparation areas the proper height.

>

* While we have done our best to design cabinetry to fit most ceramic grills, please refer to your ceramic grill manufacturer's specifications for compatibility, required height of the lower deck and distance from obstructions to allow lids to open freely.



Bowed fronts on our ceramic grill cabinets allow clearance for lid to open while keeping the base cabinets at a standard depth.

<

standard ceramic grill cabinets



Ceramic Grill Cabinet With 2 Doors



Available 30 1/2"H
and 34 1/2"H

C T E M

item-code

CGCDD33 32"H

CGCDD33 36"H

Design Considerations:

- 33"W x [30 1/2" or 34 1/2"H] x 30 3/4"D
- Interior dimensions of ceramic grill deck is 27"W x 27"D
- Left & Right sides are 3"W pilasters with finished resin

30 1/2"H Unit Dimensions:

- Top rail is 3"H
- Opening is 11"H
- No middle rail
- Doors are 11 7/8"H

34 1/2"H Unit Dimensions:

- Top rail is 3"H
- Opening is 12"H
- Middle rail is 3"H
- Doors are 11 7/8"H

Ceramic Grill Cabinet With 2 Drawers



Available 30 1/2"H
and 34 1/2"H

C T E M

item-code

CGC2D33 32"H

CGC2D33 36"H

Design Considerations:

- 33"W x [30 1/2" or 34 1/2"H] x 30 3/4"D
- Interior dimensions of ceramic grill deck is 27"W x 27"D
- Left & Right sides are 3"W pilasters with finished resin

30 1/2"H Unit Dimensions:

- Top rail is 3"H
- Opening is 11"H
- No middle rail
- Drawers are 11 7/8"H

34 1/2"H Unit Dimensions:

- Top rail is 3"H
- Opening is 12"H
- Middle rail is 3"H
- Drawers are 11 7/8"H

Open Top Ceramic Grill Cabinet



Available 30 1/2"H
and 34 1/2"H

C T E M

item-code

CGC2DOP33 32"H

CGC2DOP33 36"H

Design Considerations:

- 33"W x [30 1/2" or 34 1/2"H] x 30 3/4"D
- Interior dimensions of ceramic grill deck is 27"W x 29 1/4"D
- Left & Right sides are 3"W pilasters with finished resin

30 1/2"H Unit Dimensions:

- Top opening is 11"H
- No middle rail
- Drawers are 11 7/8"H

34 1/2"H Unit Dimensions:

- Top opening is 15"H
- Middle rail is 3"H
- Drawers are 11 7/8"H

Species available: **C** CypressKast **T** TeakKast **E** Euro **M** Metro

* **Note:** These values (*) are not subject to Door Style or Finish upcharges.

ceramic grill
cabinets



bowed ceramic grill cabinets

Suspended



19"H

C T

item-code

CGCBS33

With End Panels



34 1/2"H

C T

item-code

CGCBPN33

CGCBPN36

CGCBPN36XL

With End Panels & Drawer



34 1/2"H

C T

item-code

CGCBPN33DR

CGCBPN36DR

CGCBPN36XLDR

Design Considerations:

- The bowed section of the 33"W unit is 27"W, 25"D on sides and 34"D to tip of radius
- The bowed section of the 36"W unit is 30"W, 30"D on the sides and 34"D to tip of radius
- The bowed section of the 36"XL unit is 30"W, 30"D on the sides and 36"D to tip of radius to fit extra large ceramic grills
- Interior dimensions of ceramic grill deck: 33"W unit = 24"W x 29 1/2"D; 36"W = 27"W x 29 1/2"D; 36"XL = 27"W x 31 1/2"D
- Left & Right sides are 3"W pilasters with finished resin
- Suspended cabinet is designed to be installed between base cabinets or end panel
- The 9"H gap between radius sections is standard
- 34 1/2"H ceramic grill with end panels can be reduced to 30 1/2"H
- The option with bowed drawer features full extension, side-mounted stainless steel drawer tracks
- The drawer is 12 1/2"H and is useful for charcoal or accessory storage

If Primo oval is used, the countertop will need to have a notch cut out to lower hinge.
Please refer to the spec sheets and cut out template for your model on www.primogrill.com.

primo cabinets

With 2 Doors



34 1/2"H

C T E

item-code

CGCDD36PR34.5

CGCDD42XLPR34.5

With 2 Drawers



34 1/2"H

C T E M

item-code

CGC2D36PR34.5

CGC2D42XLPR34.5

Design Considerations:

- [36" or 42"W] x 34 1/2"H x 33"D
- Left & Right sides are 3"W pilasters with finished resin

Dimensions:

- Top rail is 3"H
- Opening is 9"H
- Interior dimensions of ceramic grill deck:
36"W unit = 30"W x 29 1/4"D
42"W unit = 36"W x 29 1/4"D
- Doors/Drawers are 17 7/8"H

ceramic grill combination cabinets



Small Combination



C T E M

item-code

CGCBCD48(L,R)

CGCBCD51(L,R)

CGCBCD54(L,R)

Design Considerations:

- [48", 51" or 54"W] x 34 ½"H x 30 ¾"D
- Interior dimensions of the ceramic grill deck is 29 ¼"W x 27"D
- The 48"W unit has 1 - 12"W cabinet
- The 51"W unit has 1 - 15"W cabinet
- The 54"W unit has 1 - 18"W cabinet
- Left & Right sides are 3"W pilasters with finished resin
- There are 2 - 14 7/8"W x 11 7/8"H deep drawers below the ceramic grill
- This cabinet may ship separately and require basic installation

Drawer Combination



C T E M

item-code

CGCBC57

CGCBC63

CGCBC69

Design Considerations:

- [57", 63" or 69"W] x 30 ¾"D
- Interior dimensions of the ceramic grill deck is 25 ½"W x 27"D
- The 57"W unit has 2 - 15"W cabinets
- The 63"W unit has 2 - 18"W cabinets
- The 69"W unit has 2 - 21"W cabinets
- There are 2 - 13 3/8"W x 11 7/8"H deep drawers below the ceramic grill
- This cabinet ships separately as two side cabinets and the ceramic grill section with two loose resin panels to finish the interior of the ceramic grill area

Bowed Combination



C T

item-code

CGCBSC57

CGCBSC63

CGCBSC69

CGCBSC72XL

Design Considerations:

- [57", 63", 69" or 72"W] x 30 ¾"D
- Interior dimensions of ceramic grill deck for 72"XL unit is 27"W x 31 ½"D and other units are 24"W x 29 ½"D
- Depth of the 72XL is 36" to tip of radius and the others are 34" deep to tip of the radius
- The 57"W unit has 2 - 15"W x 25"D cabinets
- The 63"W unit has 2 - 18"W x 25"D cabinets
- The 69"W unit has 2 - 21"W x 25"D cabinets
- The 72XL unit has 2 - 21"W x 30"D cabinets
- The 9"H gap between the lower shelf and upper rail is standard
- This combination cabinet ships in 5 pieces, allowing the ceramic grill to be adjusted to the optimal height before attaching the finished end panels to the adjacent base cabinets



grill accessory cabinets

Accessory Cabinet



CTEM

item-code

BEA18(L,R)

Design Considerations:

- Overall cabinet depth is 24"D
- Includes a centered interior cabinet line matched PVC partition
- Includes a slide out tray
- Designed for tray divider

2 Door Accessory Cabinet



CTEM

item-code

BEA30

Design Considerations:

- Overall cabinet depth is 24"D
- 2 - 15"W doors
- Includes a full-depth centered interior partition
- There is an additional partition centered in the left door
- Includes a slide out tray
- Designed for tray divider and charcoal storage

charcoal slide out

Charcoal Slide Out



CTEM

item-code

BCHSO18

Design Considerations:

- Overall cabinet depth is 24"D
- An 8" deep slide out bin is attached to door



cooktop base
cabinets



cooktop base specifications

 NatureKast® Evo cooktop cabinets have been designed around the inherent characteristics of this distinctive cooktop to greatly enhance your outdoor cooking experience. The Evo Cooktop is a must-have for any outdoor kitchen, providing cooking versatility, distinct design and a social space for entertaining guests.

- Our current range of Evo cooktop cabinets are specifically **designed for the Evo Affinity 25G or 30G.**
- Evo 30G cooktop cabinets need to be 33"D at the sides, 25G needs to be 29"D (to allow sufficient countertop behind the cooktop), so please factor this into your design
- **Do not use the Evo trim kit.** The Evo trim kit requires a Grill Base cabinet of 45" or wider and 33" or deeper for the 30G and 39" or wider and 29" or deeper for the 25G
- Lid storage cabinets have grill panels, which are easily cut on site to fit the cooktop control panel height
- Our bowed drawer cabinets feature distinctive bowed drawers to increase storage space under the Evo circular cooktop. Aside from the obvious storage enhancements, it also looks better than allowing the control panel to protrude in front of a straight cabinet. We are the first cabinet company to offer this solution.



Inspired by Jack Wills Outdoor Living



^
The Evo combination cabinet offers the ultimate in storage and rich features.
>



<
Our unique bowed drawer design increases storage space below the radius of the Evo cooktop while adding a classy look to your backyard.
>

evo cooktop bowed cabinets



Evo Combination Cabinet with 2 Bowed Drawers



COOKTOP NOT INCLUDED



item-code

GBEVO42COMBO_25G

GBEVO45.75COMBO_30G

Design Considerations:

- This cabinet has two 10"H bowed drawers and front rail is 3"H
- Side cabinets are 30" H (plus adjustable leg levelers).
- Sides are unfinished
- Features a 9"W spice cabinet and a 9"W organizer pull out
- When connecting the gas line, first attach an elbow connector to the Evo chassis to prevent needing to notch the top drawer
- Lid **will not** fit in these storage drawers

25G Unit Dimensions:

- Cabinet is 42" wide, bowed section is 33 ¼"D
- 28" deep side cabinets

30G Unit Dimensions:

- Cabinet is 45 ¾" wide, bowed section is 39 ¼"D
- 32" deep side cabinets

Evo Cabinet with 2 Bowed Drawers



COOKTOP NOT INCLUDED



item-code

GBEVO2D30_25G

GBEVO2D33.5_30G

Design Considerations:

- This cabinet has two 10"H bowed drawers and front rail is 3"H
- Pilasters are 3"W, 34 ½"H & 33"D [25G] or 29"D [25G]
- The **cooktop drip tray overhangs the pilasters** and is usually installed between adjacent cabinets to give counter overhang support at the sides
- When connecting the gas line, first attach an elbow connector to the Evo chassis to prevent needing to notch the top drawer
- Lid **will not** fit in these storage drawers

25G Unit Dimensions:

- Cabinet is 30" wide, bowed section is 34 ¼"D

30G Unit Dimensions:

- Cabinet is 33 ½" wide, bowed section is 40 ¼"D

IMPORTANT NOTE: Please do not install toe kick under the bowed drawer to allow air flow to the Evo cooktop or use grill vents

Species available: CypressKast TeakKast Euro Metro

* Note: These values (*) are not subject to Door Style or Finish upcharges.

cooktop base
cabinets



evo cooktop lid storage cabinets

Evo Combination Cabinet with Lid Shelf & 1 Bowed Drawer



COOKTOP NOT INCLUDED



item-code

GBEVO1D48COMBO_25G

GBEVO1D51.75COMBO_30G

Design Considerations:

- This cabinet has one 10"H bowed drawer
- Side cabinets are 30" H (plus adjustable leg levelers).
- Sides are unfinished
- Features a 9"W spice cabinet and a 9"W organizer pull out
- When connecting the gas line, first attach an elbow connector to the Evo chassis to prevent needing to notch the top drawer
- Lid storage shelf
- Interior finished panels ship loose to prevent needing to notch the lid shelf countertop

25G Unit Dimensions:

- Cabinet is 42" wide, bowed section is 33 1/4"D
- 28" deep side cabinets

30G Unit Dimensions:

- Cabinet is 45 3/4" wide, bowed section is 39 1/4"D
- 32" deep side cabinets

Evo Cabinet with Lid Shelf



COOKTOP NOT INCLUDED



item-code

GBEVOSH36_25G

GBEVOSH40_30G

Design Considerations:

- This cabinet has a 3"H shelf for storing the cooktop lid
- Pilasters are 3"W, 34 1/2"H & 33"D [25G] or 29"D [25G]
- Front grill panel is 12"H
- Cabinet has an inner PVC chassis to secure the Evo mounting brackets

25G Unit Dimensions:

- Total cabinet width is 30"W, pilaster is 29"D

30G Unit Dimensions:

- Total cabinet width is 40"W, pilaster is 33"D



Evo Cabinet with 1 Lid Drawer & 2 Drawers



COOKTOP NOT INCLUDED

CTEM

item-code

GBEVO3D30_25G

GBEVO3D36_30G

Design Considerations:

- This cabinet has one 11 7/8"H lid storage drawer and two 5 7/8"H regular storage drawers
- Cabinet is 30" H (plus adjustable leg levelers – 4 1/2"H is standard)
- Front Grill panel is 11 7/8"H
- Cabinet box has inner PVC chassis to use for attaching Evo mounting brackets
- The **cooktop overhangs the cabinet gables** and is usually installed with pilasters or between adjacent cabinets to give counter overhang support at the sides
- When connecting the gas line, first attach an elbow connector to the Evo chassis to feed the gas line behind the drawer
- Top drawer has 26"D drawer tracks (30G) or 24"D (25G)
- Lower drawers have 22" drawer tracks
- Cabinet has grill vents to allow required air flow

Evo Cabinet with 1 Lid Drawer & 1 Drawer



COOKTOP NOT INCLUDED

CTEM

item-code

GBEVO-2D30_25G

GBEVO-2D36_30G

Design Considerations:

- This cabinet has one 11 7/8"H lid storage drawer and one 5 7/8"H regular storage drawer
- Cabinet is 30" H (plus adjustable leg levelers – 4 1/2"H is standard)
- Front Grill panel is 11 7/8"H
- Cabinet box has inner PVC chassis to use for attaching Evo mounting brackets
- The **cooktop overhangs the cabinet gables** and is usually installed with pilasters or between adjacent cabinets to give counter overhang support at the sides
- When connecting the gas line, first attach an elbow connector to the Evo chassis to feed the gas line behind the drawer
- Lower drawer has 26"D drawer tracks (30G) or 24"D (25G)
- Top drawer has 22" drawer tracks
- Cabinet has grill vents to allow required air flow





galley suite
cabinets



NatureKast Galley Workstation Suite specifications

☑ NatureKast® takes our partnerships with high-end appliance manufacturers very seriously. So much so that we have built a storage solution to effectively cater for all the great Galley accessories when not in use. The result is the ☑ NatureKast® Galley Workstation Suite. Aside from housing the Galley workstation; the drawers take care of all the great accessories that make a Galley Workstation so much more than just an outdoor kitchen sink. Interior dynamics have also been carefully considered to allow sufficient space for the plumbing requirements. Please introduce your plumber to the drawer configuration of your new Galley Suite to ensure plumbing is done correctly the first time

- Now features a **more compact drawer configuration** which allows **3 ¼" chase space** at the back of the cabinets for plumbing and space for the Galley Tap hose
- Galley Workstation Suite is 28"D to allow space for plumbing and all the accessories
- Full access, frameless construction with ¾" thick cabinet backs
- Finished ends can be purchased loose or factory applied. Finished end panels add to overall width
- 100% stainless steel full extension side mount drawer slides (max weight: 99 lbs)
- 30"H plus an adjustable leg leveler (standard toe kick is 4 ½"H)
- Drawer box trays feature racks and slots for all the accessories with eased edges and a weld-like bond, providing superior box strength.



Greatly enhance your Galley Workstation with our elegant storage suite.
✓



NatureKast Galley Suite with 3 drawers



Suite 3: 3' Galley Workstation in 4' Galley Suite



EXCLUDES WORKSTATION AND ACCESSORIES LISTED BELOW



item-code

GWS48-3FT OWS

Design Considerations:

- This cabinet has a false front comprising two 5 7/8"H drawer fronts
- There are two 11 7/8"H drawers and one drawer with two pinned 11 7/8"H drawer fronts to produce a large 23 7/8"H drawer with tray slots and storage for the upper decks
- Cabinet is 28"D to allow space for plumbing and storage
- Cabinet top is pre cut and has inset notch for proper installation
- Slide out pinned drawer with storage for Upper Deck Set plus slots for: 1 Upper-tier Drying Rack, 1 Upper-tier Cutting Board, 2 Half Sheet Pans, 1 Upper-tier Platform
- Double slide out drawer for: 1 Colander, 1 Bowl, 1 Lower-tier Platform, 1 Upper-tier Utensil Caddy, 1 Upper-tier Garnish Board, 1 Dual-tier Condiment Serving Board

Suite 4: 4' Galley Workstation in 4' Galley Suite



EXCLUDES WORKSTATION AND ACCESSORIES LISTED BELOW



item-code

GWS48-4FT OWS

Design Considerations:

- This cabinet has a false front comprising two 5 7/8"H drawer fronts
- There are two 11 7/8"H drawers and one drawer with two pinned 11 7/8"H drawer fronts to produce a large 23 7/8"H drawer with tray slots and storage for the upper decks
- Cabinet is 28"D to allow space for plumbing and storage
- Cabinet top is pre cut and has inset notch for proper installation
- Slide out pinned drawer with storage for Upper Deck Set plus slots for: 1 Upper-tier Drying Rack, 1 Upper-tier Cutting Board, 2 Half Sheet Pans, 1 Upper-tier Platform
- Double slide out drawer for: 1 Colander, 1 Bowl, 1 Lower-tier Platform, 1 Upper-tier Utensil Caddy, 1 Upper-tier Garnish Board, 1 Dual-tier Condiment Serving Board

IMPROVED DESIGN: Now featuring 3 1/4" chase space at the back of the cabinet for plumbing and the Galley Tap hose.

IMPORTANT NOTE: Please rough-in plumbing at the back 4 1/2" of the Suite on the side with the large pinned drawer with tray slots.

Species available: **C** CypressKast **T** TeakKast **E** Euro **M** Metro

* **Note:** These values (*) are not subject to Door Style or Finish upcharges.

galley suite
cabinets



NatureKast Galley Suite with 5 drawers

Suite 5: 5' Galley Workstation in 6' Galley Suite



EXCLUDES WORKSTATION AND ACCESSORIES LISTED BELOW

C T E M

item-code

GWS72-5FT OWS

Design Considerations:

- This cabinet has a false front comprising three 5 7/8"H drawer fronts
- Four 11 7/8"H drawers and one drawer with two pinned 11 7/8"H drawer fronts to produce a 23 7/8"H drawer with tray slots and storage for the upper decks
- Cabinet is 28"D to allow space for plumbing and storage
- Cabinet top is pre cut and has inset notch for proper installation
- Slide out drawer with storage for Upper Deck Set plus slots for:
1 Upper-tier Cutting Board, 2 Half Sheet Pans
- Double slide out drawer for:
1 Colander, 1 Bowl, 1 Lower-tier Platform, 1 Upper-tier Garnish Board, 1 Dual-tier Condiment Serving Board
- Second double slide out drawer for:
1 Upper-tier Utensil Caddy, 1 Wash & Serve Basin, 1 Large Mixing Bowl, 1 Platform, 1 Dual-tier Cutting Board, 1 Dual-tier Drying Rack, 1 Colander, 1 Bowl, 1 Dual-tier Platform

Suite 6: 6' Galley Workstation in 6' Galley Suite



EXCLUDES WORKSTATION AND ACCESSORIES LISTED BELOW

C T E M

item-code

GWS72-6FT OWS

Design Considerations:

- This cabinet has a false front comprising three 5 7/8"H drawer fronts
- Four 11 7/8"H drawers and one drawer with two pinned 11 7/8"H drawer fronts to produce a 23 7/8"H drawer with tray slots and storage for the upper decks
- Cabinet is 28"D to allow space for plumbing and storage
- Cabinet top is pre cut and has inset notch for proper installation
- Slide out drawer with storage for Upper Deck Set plus slots for:
1 Upper-tier Drying Rack, 1 Upper-tier Cutting Board, 2 Half Sheet Pans
- Double slide out drawer for:
1 Colander, 1 Bowl, 1 Lower-tier Platform, 1 Upper-tier Garnish Board, 1 Dual-tier Condiment Serving Board
- Second double slide out drawer for:
1 Upper-tier Utensil Caddy, 1 Wash & Serve Basin, 1 Large Mixing Bowl, 1 Platform, 1 Dual-tier Cutting Board, 1 Dual-tier Drying Rack, 1 Colander, 1 Bowl, 1 Dual-tier Platform

IMPROVED DESIGN: Now featuring 3 1/4" chase space at the back of the cabinet for plumbing and the Galley Tap hose.
IMPORTANT NOTE: Please rough-in plumbing at the back 4 1/2" of the Suite on the side with the large pinned drawer with tray slots.



Design & Installation: Linn's Prestige Kitchens



base
cabinets



standard base cabinet specifications

All  NatureKast® boxes are constructed from $\frac{3}{4}$ " black or white PVC panels, which are 100% closed cell, making them completely weatherproof with a weld-like adhesive bond that provides superior box strength.

- Full access, frameless construction
- $\frac{3}{4}$ " thick cabinet backs
- 16" deep adjustable shelves
- 110° soft-close stainless steel concealed hinges
- Finished ends can be purchased loose or factory applied. Finished end panels are $\frac{3}{4}$ " thick
- 100% stainless steel full extension soft-close side mount drawer guides (max weight: 77lbs)
- Drawer boxes are $\frac{1}{2}$ " thick PVC construction with $\frac{3}{4}$ " thick bottom
- Standard base cabinets are 30"H plus an adjustable leg leveler (standard toe kick is 4 $\frac{1}{2}$ "H).



Drawer boxes with radius edges and 100% stainless steel full extension guides. The weld-like bond makes our drawer boxes virtually indestructible.

<



Our innovative design connects our doors to our trash pull-out unit, shown with our Shaker door style.

>



Pull-out trays with full overlay scooped front will never separate.



NatureKast® interiors rival our exteriors in durability and beauty.

<

Insulated cooler drawer cabinets. New model shown here with additional storage shelf above cooler drawer.

>



standard base cabinets



Full Height Door



C T E M

item-code

BFH9(L,R)
BFH10.5(L,R)
BFH12(L,R)
BFH13.5(L,R)
BFH15(L,R)
BFH16.5(L,R)
BFH18(L,R)
BFH19.5(L,R)
BFH21(L,R)
BFH24(L,R)

Design Considerations:

- (L,R) refers to door hinge location

Shelves:

- 1 adjustable shelf

2 Full Height Doors



C T E M

item-code

BFH24
BFH27
BFH30
BFH33
BFH36
BFH39
BFH42

Partitions:

- 36"W & 39"W cabinets will have a centered interior partition

Shelves:

- 1 adjustable shelf (on either side of the partition if applicable)

Door & Drawer



C T E M

item-code

B1D12(L,R)
B1D13.5(L,R)
B1D15(L,R)
B1D16.5(L,R)
B1D18(L,R)
B1D19.5(L,R)
B1D21(L,R)

Design Considerations:

- (L,R) refers to door hinge location

Shelves:

- 1 adjustable shelf

2 Doors & 1 Drawer



C T E M

item-code

B1D24
B1D27
B1D30
B1D33
B1D36

Partitions:

- 36"W cabinet will have a centered interior partition

Shelves:

- 1 adjustable shelf (on either side of the partition if applicable)

Species available: **C** CypressKast **T** TeakKast **E** Euro **M** Metro

* **Note:** These values (*) are not subject to Door Style or Finish upcharges.



drawer base cabinets

2 Door & 2 Drawer



C T E M

item-code

B2D30

B2D33

B2D36

B2D42

Partitions:

- 30"W & 33"W cabinets will have a centered interior mini partition to support drawers
- 36"W & 42"W cabinets will have a full centered interior partition to support drawers

Shelves:

- 30"W & 33"W cabinets will have 1 adjustable shelf
- 36"W & 42"W cabinets will have an adjustable shelf on either side of the center partition

3 Drawer



C T E M

item-code

B3D12

B3D15

B3D18

B3D21

B3D24

B3D27

B3D30

B3D33

B3D36

Design Considerations:

- Top drawer is 5 $\frac{7}{8}$ "H
- Middle and bottom drawers are 11 $\frac{7}{8}$ "H

4 Drawer



C T E M

item-code

B4D12

B4D15

B4D18

B4D21

B4D24

B4D27

B4D30

B4D33

B4D36

Design Considerations:

- Top and middle drawers are 5 $\frac{7}{8}$ "H
- Bottom drawer is 11 $\frac{7}{8}$ "H

sink bases

Farm Sink



C T E M

item-code

FS30

FS33

FS36

Design Considerations:

- Front panel is 11 $\frac{7}{8}$ "H.
- Doors are 17 $\frac{7}{8}$ "H.
- Farm sink panel will be cut to fit sink on site.
- Lower section has stretchers & risers (like grill bases) to support the sink

Partitions:

- Farm sink cabinets have a mini interior partition to support the sink weight

Shelves:

- Farm sink cabinets have no shelves



1 Full Height Door



CTEM

item-code

SBFH15(L,R)
SBFH16.5(L,R)
SBFH18(L,R)
SBFH19.5(L,R)
SBFH21(L,R)
SBFH24(L,R)

2 Full Height Doors



CTEM

item-code

SBFH24
SBFH27
SBFH30
SBFH33
SBFH36
SBFH39
SBFH42

1 Door False Front



CTEM

item-code

SBFF15(L,R)
SBFF16.5(L,R)
SBFF18(L,R)
SBFF19.5(L,R)
SBFF21(L,R)

2 Door False Front



CTEM

item-code

SBFF24
SBFF27
SBFF30
SBFF33
SBFF36
SBFF39
SBFF42

Design Considerations:

- (L,R) refers to door hinge location

Sink Skirt:

- 2 ¼"H Sink Skirt including top stretcher

Partitions:

- Sink cabinets have no interior partition (unless requested)

Shelves:

- Sink cabinets have no shelves

Design Considerations:

- (L,R) refers to door hinge location

Sink skirt:

- 6 ½"H Sink Skirt including top and bottom stretcher

False Front:

- All false front cabinets will have one false front, except the 39"W and 42"W, which has two false fronts

Partitions:

- Sink cabinets have no centered interior partition (unless requested)

Shelves:

- Sink cabinets have no shelves



corner base cabinets

Diagonal Corner



C T E M

item-code

DCC3636(L,R)

Design Considerations:

- (L,R) refers to door hinge location
- Door is 15 3/8"W

Shelves:

- 1 full depth adjustable shelf

Hinges:

- 170° stainless steel

Corner Pie Cut



C T M

item-code

EZ3636(L,R)

Design Considerations:

- (L,R) refers to door hinge location
- Doors are 11 7/8"W

Shelves:

- 1 full depth adjustable shelf

Hinges:

- 170° stainless steel with piano hinge

Lazy Susan



C T M

item-code

LS3636(L,R)

Design Considerations:

- (L,R) refers to door hinge location
- Doors are 11 7/8"W.
- Two polymer Lazy Susans are included
- Bottom Lazy Susan is secured to fixed floor with a chrome-plated shaft and mounting brackets
- Top Lazy Susan is vertically adjustable on the central shaft

Hinges:

- 170° stainless steel with piano hinge

Full Height Blind Corner



C T E M

item-code

BLBFH42(L,R)

BLBFH45(L,R)

Design Considerations:

- (L,R) refers to door hinge location
- 42"W cabinet has a 14 7/8"W door
- 45"W cabinet has a 17 7/8"W door
- Includes a 7"W slab filler where corner cabinet joins perpendicular cabinets
- A PVC blind panel is inset between the top, bottom & sides
- 1 Adjustable shelf



waste bin cabinets

Blind Corner



C T E M

item-code

BLB1D42(L,R)

BLB1D45(L,R)

Design Considerations:

- (L,R) refers to door hinge location
- 42"W cabinet has a 14 7/8"W door
- 45"W cabinet has a 17 7/8"W door
- Includes a 7"W slab filler where corner cabinet joins perpendicular cabinets
- A PVC blind panel is inset between the top, bottom & sides
- 1 Adjustable shelf

INSTALLATION NOTE:

Please consider drawer opening clearance (22") when installing perpendicular to a grill cabinet or other protrusions (like pilasters).

Full Height Single Waste Bin



C T E M

item-code

BTSOFH15

BTSOFH18

BTSOFH21

Full Height Double Waste Bin



C T E M

item-code

BDTSOFH18

BDTSOFH21

Single Waste Bin with Drawer



C T E M

item-code

BTSO1D15

BTSO1D18

BTSO1D21

Double Waste Bin with Drawer



C T E M

item-code

BDTSO1D18

BDTSO1D21

Design Considerations:

- All cabinets have either one or two 37 quart grey plastic waste bins
- These trash bins do not have lids
- Cans are fitted in a routed cabinet matched PVC shelf and are suspended by cabinet interior matched PVC arms on either side
- These cabinets come with full extension, side-mounted drawer tracks
- Single waste bin cabinets may be reduced to a minimum depth of 17"
- Double waste bin cabinets may be reduced to a minimum depth of 22"



slide out cabinets

Storage Hamper



C T E M

item-code

BHSO1D18

Design Considerations:

- 6"H top drawer for extra storage
- Slide-out storage hamper
- Cabinet Dimensions:
18"W x 34 ½"H x 24"D

Spice



C T E M

item-code

SPOFH12

SPOFH15

Design Considerations:

- Unit contains 3 spice shelves made of cabinet interior matched PVC
- Top and Bottom shelves are fixed, the center shelf is adjustable
- These cabinets come with full extension, side-mounted drawer tracks

Cutlery & Spice



C T E M

item-code

CSPFH15

Design Considerations:

- Shelves are made of cabinet line matched PVC
- Top shelf contains 6 stainless steel cutlery cups
- Middle shelf is adjustable
- Bottom shelf is fixed
- These cabinets come with full extension, side-mounted drawer tracks

Propane Pull Out



C T E M

item-code

PPOFH18 (L,R)

Design Considerations:

- (L,R) refers to door hinge location
- Propane pull out is cabinet line matched PVC and mounted on full extension, side-mounted drawer tracks
- Propane pull out has a hole cut in it to receive the bottom flange of standard 20 lbs BBQ propane tank
- Tank not included

cooler pull out cabinets



1 Full Height Door Cooler Roll-Out

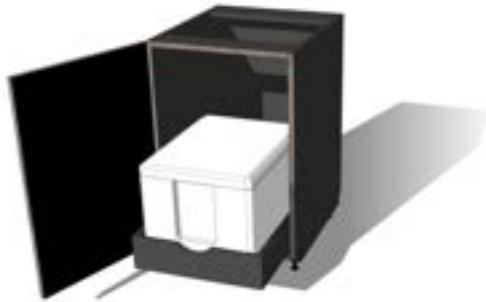

item-code

COOLER INCLUDED

CSOYFH21(L,R)

CSOYFH24(L,R)

COOLER NOT INCLUDED

CSOCFH21(L,R)

CSOCFH24(L,R)

2 Full Height Door Cooler Roll-Out



item-code

COOLER INCLUDED

CSOYFH36

CSOYFH39

COOLER NOT INCLUDED

CSOCFH36

CSOCFH39

Design Considerations:

- (L,R) refers to door hinge location
- Pull out is cabinet line matched PVC
- Will work with 21"W x 15 1/2"H x 16"D Yeti Ice Cooler (35 qt) or similar
- Cooler fits sideways front to back in the pull out
- Full extension glides allow cooler to be opened completely when pull out is fully open

Design Considerations:

- Pull out is cabinet-line matched PVC
- Will work with 30 1/2"W x 16"H x 17.5"D Yeti Ice Cooler (65 qt) or similar
- Cooler fits from side to side in the pull out
- Full extension glides allow cooler to be opened completely when pull out is fully open

PLEASE NOTE: Sovaro coolers have been discontinued. Our Sovaro cabinets are no longer available.



cooler drawer cabinets

1 Full-Height Cooler Drawer



C T E M

item-code

CSBFH1D18

CSBFH1D21

Design Considerations:

- Slide-out Integral Cooler 22"H (18"W or 21"W)
- These cabinets come with full extension, side-mounted drawer tracks
- 8 1/2"H additional storage space on shelf above the cooler
- Fully insulated cooler drawer with drain plug

Cooler Drawer Interior Dimensions:

- (Cabinet Width - 6") x 15"H x 19 1/4"D

2 Drawer 1 Cooler



C T E M

item-code

CSB2D18

CSB2D21

Design Considerations:

- Slide-out Integral Cooler 24"H (18"W or 21"W)
- These cabinets come with full extension, side-mounted drawer tracks
- 6"H top drawer for extra storage
- Fully insulated cooler drawer with drain plug

Cooler Drawer Interior Dimensions:

- (Cabinet Width - 6") x 18"H x 19 1/4"D

3 Drawer 1 Cooler



C T E M

item-code

CSB3D15

CSB3D18

CSB3D21

CSB3D24

CSB3D27

CSB3D30

CSB3D33

Design Considerations:

- Top drawer is 5 7/8"H
- Middle drawer is a fully insulated cooler drawer with drain plug
- Middle and bottom drawers are 11 7/8"H

Cooler Drawer Interior Dimensions:

- (Cabinet Width - 6") x 6 1/2"H x 19 1/4"D

1 Cooler Drawer - 12"H



C T E M

item-code

CSS1D3012

CSS1D3612

Design Considerations:

- Drawer is 11 7/8"H
- Fully insulated cooler drawer with drain plug installed at bottom

Cooler Drawer Interior Dimensions:

- (Cabinet Width - 6") x 6 1/2"H x 19 1/4"D

warming drawer cabinets

2 Door Warming Drawer



CTEM

item-code

BWD30

BWD36

Design Considerations:

- Warming drawer panel is 11 7/8"H
- Doors are 17 7/8"H
- Warming drawer panel will be cut to fit drawer on site
- Cabinet has stretchers and risers (like grill bases) to support the warming drawer

Partitions:

- 36"W cabinets have 1 partition centered in the cabinet

2 Drawer Warming Drawer



CTEM

item-code

BW2D30

BW2D36

Design Considerations:

- Warming drawer panel is 11 7/8"H
- Upper drawer is 5 7/8"H
- Lower drawer is 11 7/8"H
- Warming drawer panel will be cut to fit drawer on site
- Cabinet has stretchers and risers (like grill bases) to support the warming drawer

specialty cabinets

Tray Divider



CTEM

item-code

BTRYFH9(L,R)

BTRYFH12(L,R)

BTRYFH15(L,R)

Design Considerations:

- (L,R) refers to door hinge location

Partitions:

- Includes a centered interior cabinet line matched PVC partition
- Designed for tray divider and charcoal storage

1 Drawer Bench



CTEM

item-code

BN1D24

BN1D30

BN1D36

2 Drawer Bench



CTEM

item-code

BN2D36

BN2D42

BN2D48

BN2D60

Design Considerations:

- This cabinet/bench is 12"H plus an adjustable leg leveler (standard toe kick is 4 1/2"H)
- Drawer fronts are 11 7/8"H
- Resin is not recommended as a top for this bench cabinet





Picture: C&C Diversified Gas



wall
cabinets



standard wall cabinet specifications

All  NatureKast® boxes are constructed from ¾" black or white PVC panels, which are 100% closed cell, making them completely weatherproof with a weld-like adhesive bond that provides superior box strength

- Full access, frameless construction
- ¾" thick cabinet backs. Screws can be used anywhere on the back panel
- Use washers with stainless steel screws when hanging wall cabinets
- Wall cabinets are 12" deep and come with full depth ¾" thick PVC adjustable shelves
- Cabinet depth can be increased to 24" with 16" deep Shelves (See Cabinet Size Increase Modification charge)
- 110° soft-close solid stainless steel 35mm cup, hinge body, and back plate including 3 Hinges on full height doors
- Finished ends can be purchased loose or factory applied. Finished end panels are ¾" thick.



Picture: Jeffrey A. Davis Photography Inc.

standard wall cabinets



1 Door Cabinet



item-code

18"H

W13.518(L,R)

W1518(L,R)

W1818(L,R)

W19.518(L,R)

W2118(L,R)

24"H

W1224(L,R)

W13.524(L,R)

W1524(L,R)

W16.524(L,R)

W1824(L,R)

W19.524(L,R)

W2124(L,R)

item-code

30"H

W930(L,R)

W10.530(L,R)

W1230(L,R)

W13.530(L,R)

W1530(L,R)

W16.530(L,R)

W1830(L,R)

W19.530(L,R)

W2130(L,R)

W2430(L,R)

36"H

W1236(L,R)

W1536(L,R)

W1836(L,R)

Design Considerations:

- (L,R) refers to door hinge location

Shelves:

- 18"H & 24"H cabinets - no shelves
- 30"H cabinets - 1 adjustable shelf
- 36"H cabinets - 2 adjustable shelves

2 Door Cabinet



item-code

18"H

W2718

W3018

W3318

W3618

W3918

W4218

24"H

W2424-2

W2724

W3024

W3324

W3624

W3924

W4224

item-code

30"H

W1830-2

W2130-2

W2430-2

W2730

W3030

W3330

W3630

W3930

W4230

W4830

36"H

W2436-2

W3036

W3636

Partitions:

- Cabinets 36"W and wider will have a centered interior partition

Shelves:

- 18"H & 24"H cabinets - no shelves
- 30"H Cabinets - 1 adjustable shelf (on both sides of the partition if applicable)
- 36"H cabinets - 2 adjustable shelves (on both sides of the partition if applicable)

Species available: **C** CypressKast **T** TeakKast **E** Euro **M** Metro



stacked door cabinets

1 Stacked Door



C T E M

item-code

42"H

SW1542(L,R)

SW1842(L,R)

SW2142(L,R)

2 Stacked Doors



C T E M

item-code

42"H

SW3042

SW3642

Design Considerations:

- Upper and lower doors are pinned together
- Upper door is 17 7/8"H
- There is no fixed floor between the upper and lower doors
- (L,R) refers to door hinge location
- Euro, Metro and Contempo may be ordered as single doors instead of pinned doors

Partitions:

- 36"W cabinets will have a centered interior partition

Shelves:

- 42"H Cabinets - 2 adjustable shelves (on both sides of the partition if applicable)

stacked appliance cabinets

Stacked Cabinet with 2 Doors



C T E M

item-code

48"H

SWA1548(L,R)

SWA1848(L,R)

54"H

SWA1554(L,R)

SWA1854(L,R)

Stacked Cabinet with 4 Doors



C T E M

item-code

48"H

SWA3048

SWA3648

54"H

SWA3054

SWA3654

Design Considerations:

- Upper & lower doors open separately.
- Lower door is 17 7/8"H
- There is a fixed floor between the upper and lower doors
- There is no bottom floor in stacked appliance cabinets
- (L,R) refers to door hinge location

Partitions:

- 36"W cabinets will have a centered interior partition behind the top doors only

Shelves:

- 48"H & 54"H cabinets - 2 adjustable shelves in the upper section (on both sides of the partition if applicable)

corner wall cabinets



Diagonal Wall Cabinet 1 Door



CTEM

item-code

WDCC262618(L,R)

WDCC262624(L,R)

WDCC262630(L,R)

WDCC262636(L,R)

Shelves:

- 18"H & 24"H cabinets - no shelves
- 30"H cabinets - 1 adjustable shelf
- 36"H cabinets - 2 adjustable shelves

Diagonal Wall Cabinet with 2 Stacked Doors



CTEM

item-code

SWDCC262642(L,R)

Design Considerations:

- Upper and lower doors are pinned together
- Upper door is 17 7/8"H
- There is no fixed floor between the upper and lower doors
- (L,R) refers to door hinge location
- Euro, Metro and Contempo may be ordered as single doors instead of pinned doors

Shelves:

- 2 adjustable shelves



Picture: SR Design Group



standard tall cabinet specifications

All  NatureKast® tall cabinets are constructed from ¾" Black or White PVC panels, which are 100% closed cell, making them completely weatherproof with a weld-like adhesive bond that provides superior box strength.

- Bottom two doors are attached and open as one door.
- 3 adjustable Shelves come in lower section and one in upper section.
- Tall cabinets come with full depth shelves in 12" deep cabinets and 16" deep Shelves in 24" deep cabinets.
- Tall cabinets are great for cushion storage.
- Center legs added for 30" and 36" wide tall cabinets for extra support.
- Height of Tall cabinet is 90"H plus an adjustable leg leveler (standard toe kick is 4 ½"H).
- Overall height is 94 ½"H



wall depth tall cabinets

2 Door Cabinet



C T M

item-code

T1294.5-12(L,R)

T1594.5-12(L,R)

T1894.5-12(L,R)

Design Considerations:

- This cabinet consists of 3 - 30"H doors
- The 2 lower doors are pinned together
- Contempo may be ordered as single doors instead of pinned doors

Shelves:

- There is a fixed shelf located between the top door and pinned lower doors
- The top section has 1 adjustable shelf
- The lower section has 3 adjustable shelves

4 Door Cabinet



C T M

item-code

T2494.5-12

T3094.5-12

T3694.5-12

Design Considerations:

- This cabinet consists of 6 - 30"H doors
- The 2 lower doors are pinned together
- Contempo may be ordered as single doors instead of pinned doors

Partitions:

- The 36"W cabinet will have a centered interior partition

Shelves:

- There is a fixed shelf located between the top door and pinned lower doors*
- The top section has 1 adjustable shelf*
- The lower section has 3 adjustable shelves*

*On both sides of the partition if applicable.

base depth tall cabinets

2 Door Cabinet



C T M

item-code

T1294.5-24(L,R)

T1594.5-24(L,R)

T1894.5-24(L,R)

Design Considerations:

- This cabinet consists of 3 - 30"H doors
- The 2 lower doors are pinned together
- Contempo may be ordered as single doors instead of pinned doors

Shelves:

- There is a fixed shelf located between the top door and pinned lower doors
- The top section has 1 adjustable shelf
- The lower section has 3 adjustable shelves

4 Door Cabinet



C T M

item-code

T2494.5-24

T3094.5-24

T3694.5-24

Design Considerations:

- This cabinet consists of 6 - 30"H doors
- The 2 lower doors are pinned together
- Contempo may be ordered as single doors instead of pinned doors
- 30"W & 36"W cabinets will have 6 legs for increased support

Partitions:

- The 36"W cabinet will have a centered interior partition

Shelves:

- There is a fixed shelf located between the top door and pinned lower doors*
- The top section has 1 adjustable shelf*
- The lower section has 3 adjustable shelves*

*On both sides of the partition if applicable.





standard insert cabinet specifications

Until now, the only cabinets and door fronts available for structure type outdoor kitchens have been stainless steel. NatureKast® now offers a full line of PVC cabinet boxes with doors and drawers, along with our Insert frames with doors to access existing structure areas. Wood is a beautiful accent to stone, brick, or stucco structures, but that has not been an option for anyone looking for a long term, maintenance free product. With NatureKast® insert cabinets, that is now an option. Full height doors with frames, hinges, and open backs are available to access existing interiors.

- Cabinet is surrounded by a 3" frame that adds 6" to the overall indicated width and height of the cabinet
- The frame is finished to match the doors.

INSERT FRAME DETAIL

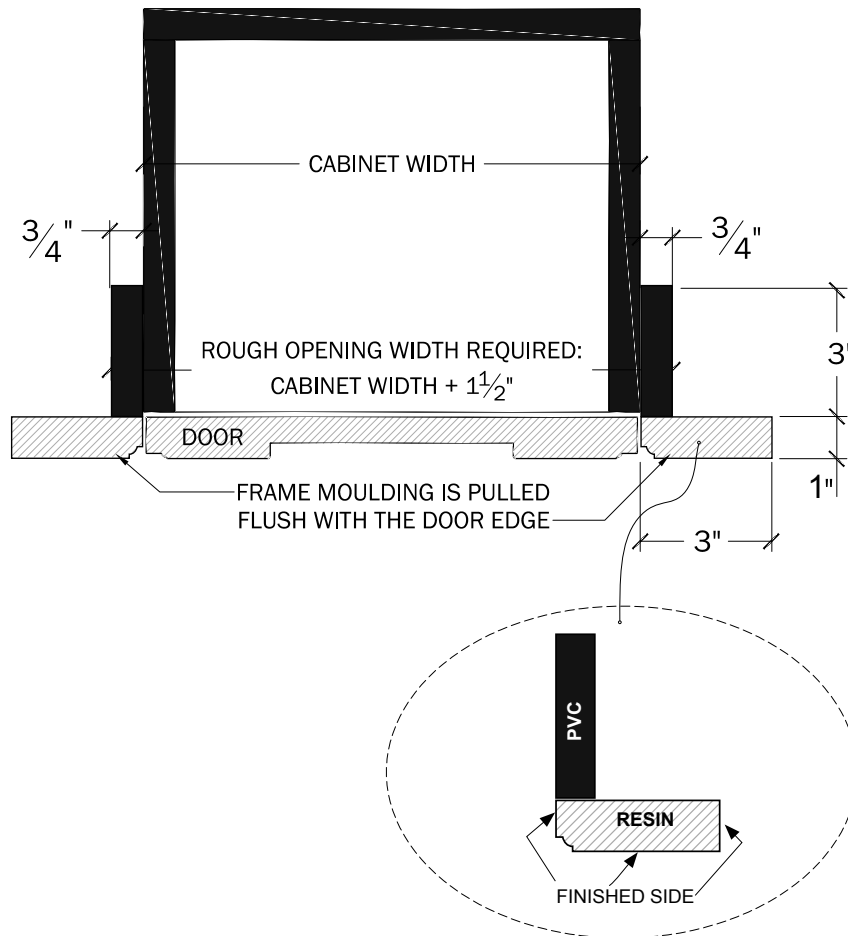

insert cabinets



1 Full Height Door



C T

item-code

18"H

ID1518(L,R)

ID1818(L,R)

1 Door & 1 Drawer



C T

item-code

24"H

I1DD1524(L,R)

I1DD1824(L,R)

I1DD2124(L,R)

2 Doors & 1 Drawer



C T

item-code

24"H

I1DD3024

I1DD3624

1 Drawer



C T

item-code

6"H

I1D2406

I1D2706

I1D3006

I1D3606

12"H

I1D2412

I1D2712

I1D3012

I1D3612

Design Considerations:

- Dimensions shown above reflect the cabinet size
- The frame extends an additional 3" on all sides
- All cabinets come with insert trim attached. Order suspended cabinets with insert trim molding separate when combining insert cabinets
- **Required** opening sizes are the sizes listed + 1 1/2" to both the width and height
- (L,R) refers to door hinge location

Species available: **C** CypressKast **T** TeakKast



2 Drawer



C T

item-code

18"H

I2D1518

I2D1818

I2D2118

I2D2418

I2D3018

24"H

I2D1524

I2D1824

I2D2124

I2D2424

I2D3024

Design Considerations:

- Opening sizes are the sizes listed + 1 1/2" to both the width and height
- The frame extends an additional 3" on all sides
- The PVC box is 24" deep
- (L,R) refers to door hinge location

Slide-out Cooler Drawer



C T

item-code

I1DCSO3615

Design Considerations:

- Slide-out integral cooler drawer 36"W x 15"H x 24"D
- Opening sizes are the sizes listed + 1 1/2" to both the width and height
- The frame extends an additional 3" on all sides
- Fully insulated cooler drawer with drain plug

insert access door cabinets

Insert Access 1 Door



C T

item-code

18"H

IAD1518(L,R)

IAD1818(L,R)

IAD2118(L,R)

24"H

IAD1224(L,R)

IAD1524(L,R)

IAD1824(L,R)

IAD2124(L,R)

Design Considerations:

- Dimensions shown above reflect the cabinet size
- Opening sizes are the sizes listed + 1 1/2" to both the width and height
- The frame extends an additional 3" on all sides
- The resin box is 6" deep
- These cabinets have no backs or shelves
- These are intended to cover and allow access to the area inside the structure
- (L,R) refers to door hinge location

Insert Access 2 Doors



C T

item-code

18"H

IAD3018

IAD3618

IAD4218

24"H

IAD2424

IAD3024

IAD3624

IAD4224

30"H

IAD2730

IAD3030



suspended
cabinets



standard suspended cabinet specifications

All  NatureKast® boxes are constructed from ¾" black or white PVC panels, which are 100% closed cell, making them completely weatherproof with a weld-like adhesive bond that provides superior box strength.

- These suspended units have been designed for installation between our standard base cabinets, end panels or our support posts with side aprons provided to create a furniture-piece look
- The suspended cabinet gives an open and airy look, while providing easy cleaning below
- Suspended cabinets can also be used as inserts when combining units. Order the insert molding from the molding section to border the combined cabinets
- If suspended cabinets are used as inserts in fully exposed areas, insert molding or some type of trim border is required to help keep the rain out of the drawers and cabinets. This trim should be at least 1" deep as the drawer fronts and doors are 1" deep.



Picture: Backyard Specialist

^

Shown: Suspended grill cabinets with aprons

standard suspended cabinets



1 Full Height Door



C T E M

item-code

18"H

SFH1518(L,R)

SFH1818(L,R)

24"H

SFH1224(L,R)

SFH1524(L,R)

SFH1824(L,R)

SFH2124(L,R)

2 Full Height Doors



C T E M

item-code

18"H

SFH3018

SFH3618

24"H

SFH2424

SFH2724

SFH3024

SFH3624

1 Door & 1 Drawer



C T E M

item-code

24"H

SD1524(L,R)

SD1824(L,R)

SD2124(L,R)

2 Doors & 1 Drawer



C T E M

item-code

24"H

S1DD3024

Design Considerations:

- (L,R) refers to door hinge location
- Shelves:
- 18"H & 24"H cabinets - no shelves

Design Considerations:

- Drawers are 5 7/8"H.
 - Doors are 17 7/8"H.
 - (L,R) refers to door hinge location.
- Shelves:
- 24"H cabinets - no shelves.



suspended drawer cabinets

1 Drawer - 6"H



C T E M

item-code

S1D2406

S1D2706

S1D3006

S1D3606

Design Considerations:

- Drawer is 5 7/8"H

1 Drawer - 12"H



C T E M

item-code

S1D2412

S1D2712

S1D3012

S1D3612

Design Considerations:

- Drawer is 11 7/8"H

2 Drawer - 18"H



C T E M

item-code

S2D1218

S2D1518

S2D1818

S2D2418

S2D3018

Design Considerations:

- Upper drawer is 5 7/8"H
- Lower drawer is 11 7/8"H

2 Drawer - 24"H



C T E M

item-code

S2D1524

S2D1824

S2D2124

S2D2424

S2D3024

Design Considerations:

- Both drawers are 11 7/8"H



suspended post ends

Grill with 2 Drawers



C T E M

item-code

SGB2D3624-28

SGB2D4224-28

Design Considerations:

- This cabinet is 28"D and 24"H
- Front panel is 11 7/8"H
- Panel can be cut on site to fit individual grills
- Drawers are 11 7/8"H

Partition:

- There is a partition separating the two sets of drawers

Resin Post Ends



C T

item-code

25" Deep

SPE2506

SPE2512

SPE2518

SPE2524

29" Deep

SPE2906

SPE2912

SPE2918

SPE2924

Design Considerations:

- Posts are 3"W x 3"D x 36"H (can be reduced to 34 1/2"H)
- Side aprons are 6"H, 12"H, 18"H & 24"H (as shown above)
- Available **25"D & 29"D**

Euro Post Ends

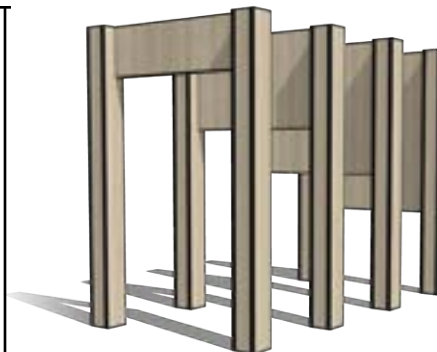

E

item-code

24 5/8" Deep

SPE24.625-06-EURO

SPE24.625-12-EURO

SPE24.625-18-EURO

SPE24.625-24-EURO

28 5/8" Deep

SPE28.625-06-EURO

SPE28.625-2-EURO

SPE28.625-18-EURO

SPE28.625-24-EURO

Design Considerations:

- Posts are 3"W x 3"D x 36"H (can be reduced to 34 1/2"H)
- Side aprons are 6"H, 12"H, 18"H & 24"H (as shown above)
- Available **24 5/8"D & 28 5/8"D**
- Euro posts will have a butt joint with door match face and ebony edge at the sides

Metro Post Ends

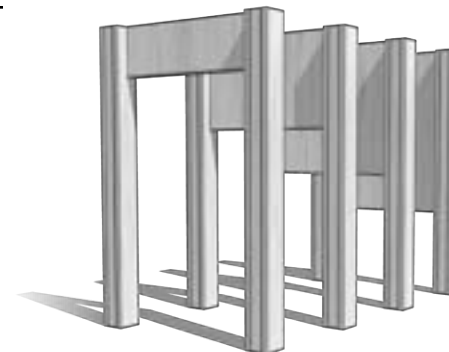

M

item-code

24 7/8" Deep

SPE2506

SPE2512

SPE2518

SPE2524

28 7/8" Deep

SPE2906

SPE2912

SPE2918

SPE2924

Design Considerations:

- Posts are 3"W x 3"D x 36"H (can be reduced to 34 1/2"H)
- Side aprons are 6"H, 12"H, 18"H & 24"H (as shown above)
- Available **24 7/8"D & 28 7/8"D**
- Metro posts will have a butt joint with door match face and smooth door colour edge



Design & Installation: Good Life New England



television
cabinets



tv cabinet specifications

Wall-Mount Frame Details

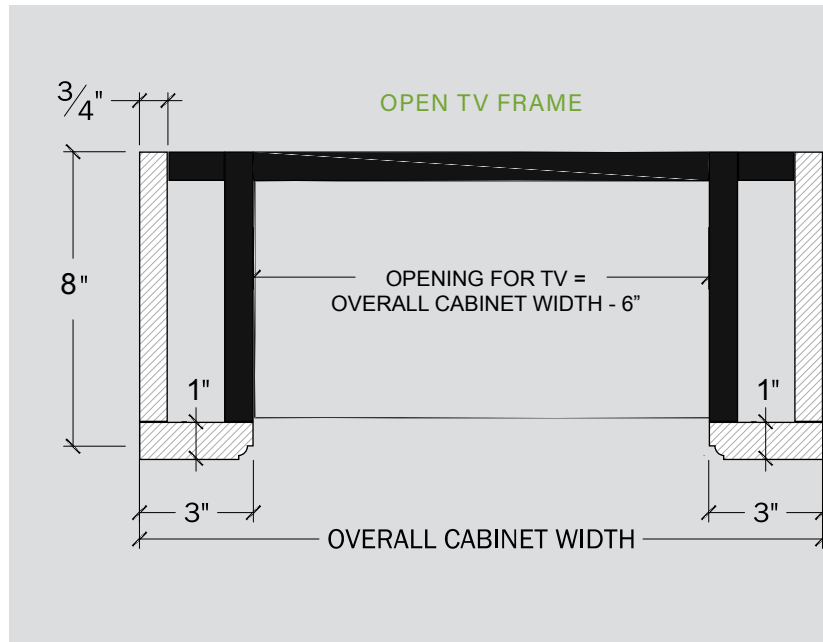

Built-In Frame Details

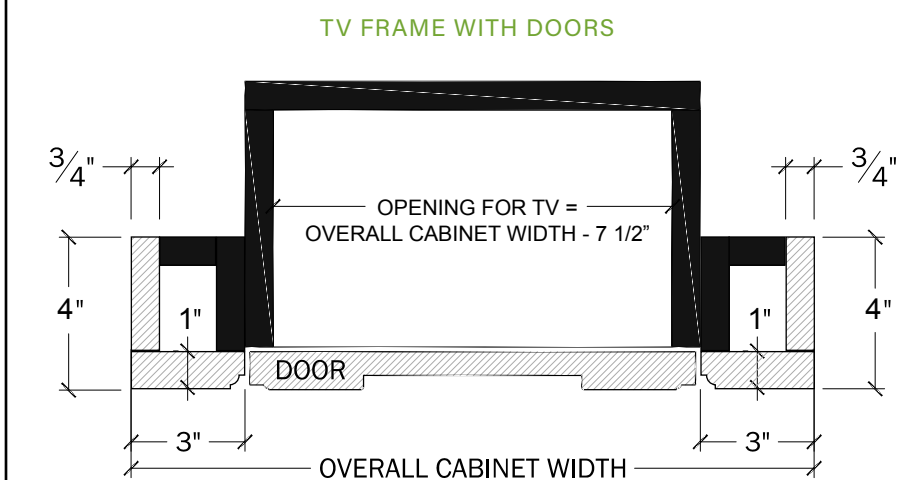
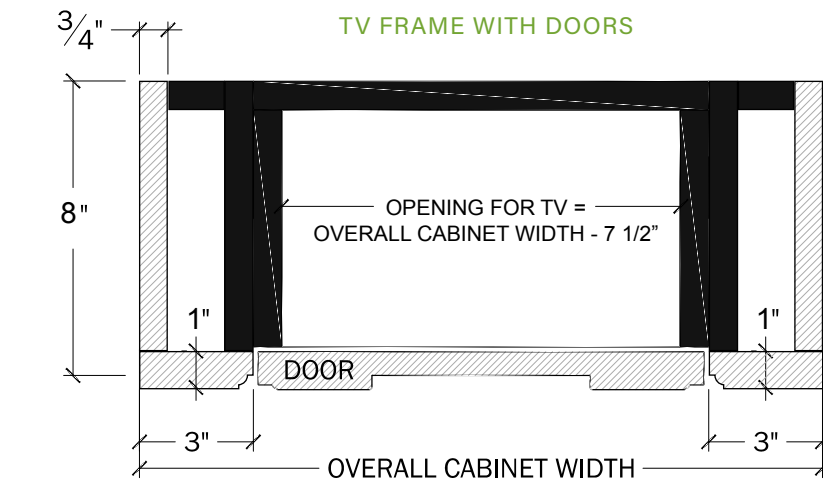
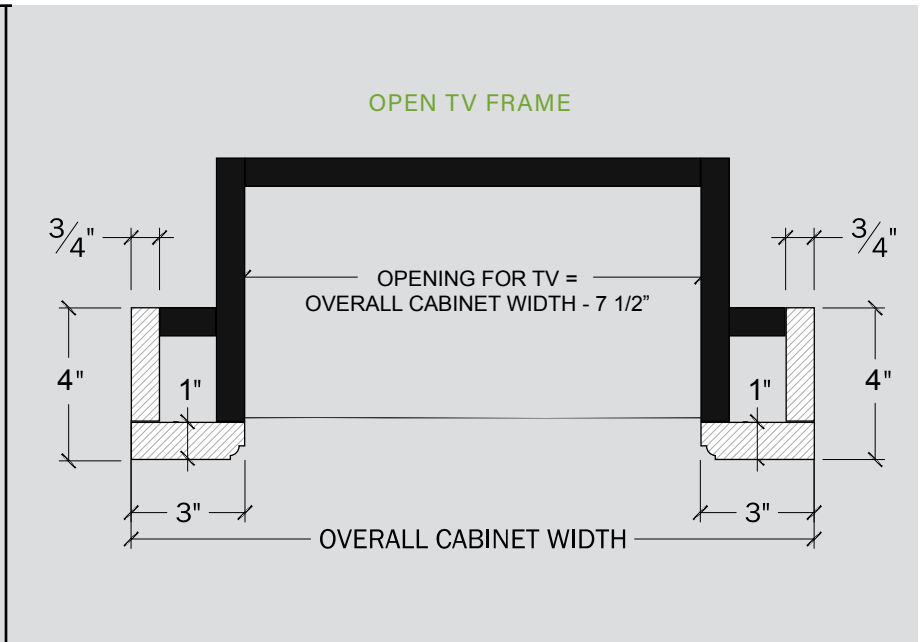

open tv frame cabinet



OPEN TV FRAME



Wall Mounted with Open TV Frame



	user-code	TV width (maximum)	TV height (maximum)
30"H	TVOF-WM3630	30"	24"
	TVOF-WM4230	36"	24"
	TVOF-WM4830	42"	24"
36"H	TVOF-WM4836	42"	30"
	TVOF-WM5436	48"	30"
42"H	TVOF-WM6042	54"	36"
	TVOF-WM6642	60"	36"

Design Considerations:

- Cabinet sides, top, and bottom of wall mounted TV cabinets are finished resin. Interior is cabinet-line matched PVC
- See page 78 for frame specifications
- Overall depth = 8"D

Built-In with Open TV Frame



	user-code	TV width (maximum)	TV height (maximum)
30"H	TVOF-B3630	30"	24"
	TVOF-B4230	36"	24"
	TVOF-B4830	42"	24"
36"H	TVOF-B4836	42"	30"
	TVOF-B5436	48"	30"
42"H	TVOF-B6042	54"	36"
	TVOF-B6642	60"	36"

Design Considerations:

- Designed to fit into masonry or other rough openings
- Cabinet sides, top, and bottom of built-in TV cabinet and interior of TV box are cabinet line matched PVC
- 3" TV Frame and return are finished resin
- See page 78 for frame specifications
- Overall depth = 8"D



bi-fold door tv cabinet

Wall-Mounted & Side-Mounted to Adjacent Wall Cabinets with Bi-Fold Doors

SHOWN WITH DOORS CLOSED



SHOWN WITH DOORS OPEN



C T

	user-code	TV width (maximum)	TV height (maximum)
36"H	TVBF2-WM5436	40 ½"	27"
	TVBF2-WM6636	52 ½"	27"
	TVBF2-WM5442	40 ½"	33"
42"H	TVBF2-WM6642	52 ½"	33"
	TVBF2-WM7842	64 ½"	33"

< shown as an assembly with
crown molding, light rail
with aluminum support
and adjacent standard wall
cabinets >

SECTIONAL DETAIL

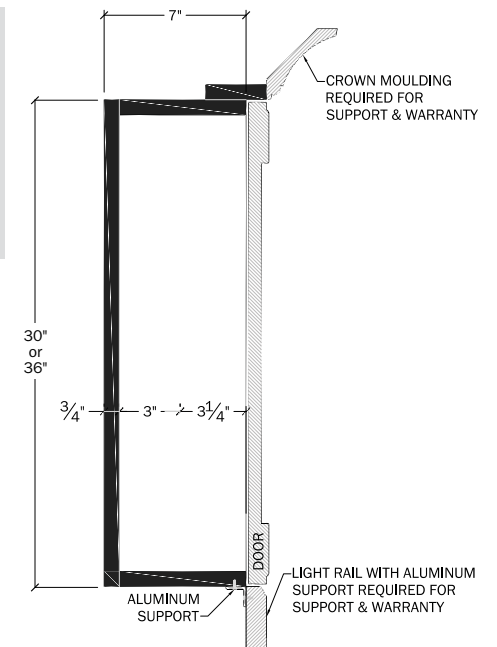

Design Considerations:

- This cabinet was designed without a top and bottom frame to be used between standard wall cabinets to maintain a consistent look
- This cabinet **MUST** include a **Crown Molding with Return (CRWNR)** and **Light Rail with Aluminum Support (LRA)** to correctly support this cabinet and to qualify for warranty
- Cabinet sides, top, and bottom of wall mounted TV cabinets are finished resin. Interior is cabinet-line matched PVC
- Cabinet is supplied with one 96" length of crown molding and light rail with aluminum support
- Doors bi-fold and open 170°. They are held in place with magnetic catches
- Doors are mounted with stainless steel hinges
- Sizes listed above are overall cabinet width including side frame. Height sizes **include** crown molding and light rail
- Overall depth = 8"D



SHOWN WITH DOORS CLOSED



Wall-Mounted with Bi-Fold Doors and 4-sided frame

C T

	user-code	TV width (maximum)	TV height (maximum)
36"H	TVBF4-WM5436	40 ½"	27"
	TVBF4-WM6636	52 ½"	27"
	TVBF4-WM5442	40 ½"	33"
42"H	TVBF4-WM6642	52 ½"	33"
	TVBF4-WM7842	64 ½"	33"

Design Considerations:

- Cabinet sides, top, and bottom of wall-mounted TV cabinets are finished resin. Interior is cabinet-line matched PVC
- Doors are mounted with stainless steel hinges
- Doors bi-fold and open 170°. They are held in place with magnetic catches
- This cabinet includes a structural aluminum support
- Sizes listed above are overall cabinet width including frame
- See page 78 for frame specifications
- Overall depth = 8"D

SHOWN WITH DOORS OPEN



Built-In with Bi-Fold Doors and 4-sided frame

C T

	user-code	TV width (maximum)	TV height (maximum)
36"H	TVBF4-B5436	40 ½"	27"
	TVBF4-B6636	52 ½"	27"
	TVBF4-B5442	40 ½"	33"
42"H	TVBF4-B6642	52 ½"	33"
	TVBF4-B7842	64 ½"	33"

Design Considerations:

- Designed to fit into masonry or other rough openings
- Cabinet sides, top, bottom and interior of built-in TV cabinets are cabinet-line matched PVC
- Doors are mounted with stainless steel hinges
- Doors bi-fold and open 170°. They are held in place with magnetic catches
- This cabinet includes a structural aluminum support
- Sizes listed above are overall cabinet width including frame
- See page 78 for frame specifications
- Overall depth = 8"D



stacked bi-fold door tv cabinet

SHOWN WITH DOORS CLOSED



Wall-Mounted with Stacked Bi-Fold Doors

C T

	user-code	TV width (maximum)	TV height (maximum)
42"H	TVBFS-WM5442	40 ½"	33"
	TVBFS-WM6642	52 ½"	33"
	TVBFS-WM7842	64 ½"	33"
48"H	TVBFS-WM6648	52 ½"	39"
	TVBFS-WM7848	64 ½"	39"

Design Considerations:

- Designed to be surface-mounted
- Interior is cabinet-line matched PVC
- Doors are mounted with stainless steel hinges
- Doors bi-fold and open 170°. They are held in place with magnetic catches
- Sizes listed above are overall cabinet width including frame
- See page 78 for frame specifications
- Overall depth = 8"D

SHOWN WITH DOORS OPEN



Built-In with Stacked Bi-Fold Doors

C T

	user-code	TV width (maximum)	TV height (maximum)
42"H	TVBFS-B5442	40 ½"	33"
	TVBFS-B6642	52 ½"	33"
	TVBFS-B7842	64 ½"	33"
48"H	TVBFS-B6648	52 ½"	39"
	TVBFS-B7848	64 ½"	39"

Design Considerations:

- Designed to fit into masonry or other rough openings
- Cabinet sides, top, bottom and interior of built-in TV cabinets are cabinet line matched PVC
- Doors are mounted with stainless steel hinges
- Doors bi-fold and open 170°. They are held in place with magnetic catches
- Sizes listed above are overall cabinet width including frame
- See page 78 for frame specifications
- Overall depth = 8"D

tv cabinets with 2 sliding doors



SHOWN WITH DOORS CLOSED



Wall-Mounted with 2 Sliding Doors



	user-code	TV width (maximum)	TV height (maximum)
36"H	TVSL-2WM7836	34 1/2"	28 1/2"
	TVSL-2WM9036	40 1/2"	28 1/2"
	TVSL-2WM10236	46 1/2"	28 1/2"
42"H	TVSL-2WM7842	34 1/2"	34 1/2"

Design Considerations:

- Designed to be surface-mounted
- Cabinet sides, top, and bottom of wall-mounted TV cabinets are finished resin. Interior is cabinet-line matched PVC
- Doors are mounted on PVC panels that slide in an aluminum glide track
- There will be a seam in the upper & lower frames in the 102"W cabinet
- Sizes listed above are overall cabinet width including frame
- See page 78 for frame specifications
- Overall depth = 8"D

SHOWN WITH DOORS OPEN



Built-In with 2 Sliding Doors



	user-code	TV width (maximum)	TV height (maximum)
36"H	TVSL-2B7836	34 1/2"	28 1/2"
	TVSL-2B9036	40 1/2"	28 1/2"
	TVSL-2B10236	46 1/2"	28 1/2"
42"H	TVSL-2B7842	34 1/2"	34 1/2"

Design Considerations:

- Designed to fit into masonry or other rough openings
- Cabinet sides, top, bottom and interior of built-in TV cabinets are cabinet-line matched PVC
- Doors are mounted on PVC panels that slide in an aluminum glide track
- There will be a seam in the upper & lower frames in the 102"W cabinet
- Sizes listed above are overall cabinet width including frame
- See page 78 for frame specifications
- Overall depth = 8"D



tv cabinets with 4 sliding doors

SHOWN WITH DOORS CLOSED



Wall-Mounted with 4 Sliding Doors

C T

	user-code	TV width (maximum)	TV height (maximum)
36"H	TVSL-4WM12636	58 ½"	28 ½"
42"H	TVSL-4WM10242	46 ½"	34 ½"
	TVSL-4WM12642	58 ½"	34 ½"

Design Considerations:

- Designed to be surface-mounted
- Cabinet sides, top, and bottom of wall-mounted TV cabinets are finished resin. Interior is cabinet-line matched PVC
- Doors are mounted on PVC panels that slide in an aluminum glide track
- There will be a seam in the upper & lower frames in the 102"W & 126"W cabinets
- Sizes listed above are overall cabinet width including frame
- See page 78 for frame specifications
- Overall depth = 8"D

SHOWN WITH DOORS OPEN

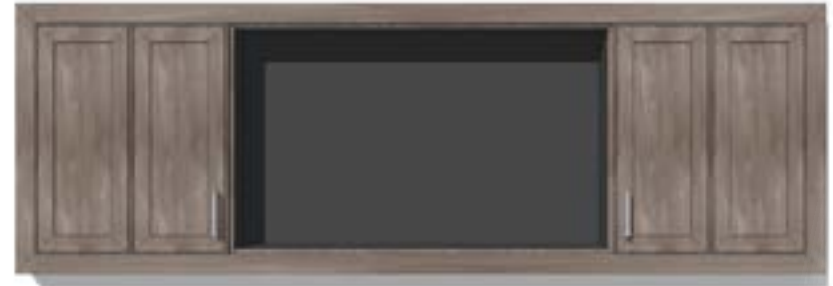

Built-In with 4 Sliding Doors

C T

	user-code	TV width (maximum)	TV height (maximum)
36"H	TVSL-4B12636	58 ½"	28 ½"
42"H	TVSL-4B10242	46 ½"	34 ½"
	TVSL-4B12642	58 ½"	34 ½"

Design Considerations:

- Designed to fit into masonry or other rough openings
- Cabinet sides, top, bottom and interior of built-in TV cabinets are cabinet-line matched PVC
- Doors are mounted on PVC panels that slide in a aluminum glide track
- There will be a seam in the upper & lower frames in the 102"W & 126"W cabinets
- Sizes listed above are overall cabinet width including frame
- See page 78 for frame specifications
- Overall depth = 8"D





shaker hood specifications

A fine example of the simplicity of the shaker design.

The Shaker hood by NatureKast® features a familiar traditional angled styling.

- Sizes: 42 ¾"W & 54 ¾"W, 36"H, 42"H & 48" high, 24 ⅜"D or 31"D
- This hood is built in three sections, with an internal plywood structural frame
- Stainless steel laminate liner can be cut on site to fit most hood inserts
- Available in all Paint, Stain & Glaze and Weathered finishes. Not currently available in Teak resin
- 100% weatherproof hood material can be used indoors or outdoors
- All hoods must be installed a minimum of 36" from the cooking surface. Check with local building codes and appliance specs
- Deeper hoods should be used over grill cabinets or any cooking appliance that is deeper than 24"

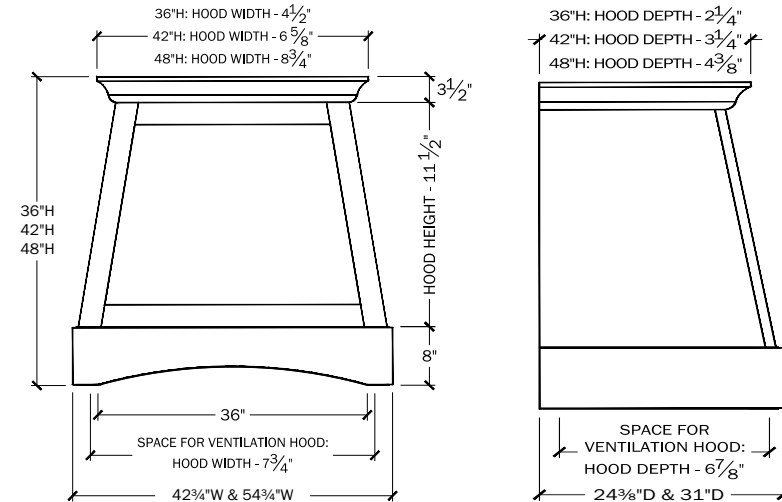

item-code	
36"H	SHHD4336-25
	SHHD4336-31
	SHHD5536-25
	SHHD5536-31
42"H	SHHD4342-25
	SHHD4342-31
	SHHD5542-25
	SHHD5542-31
48"H	SHHD4348-25
	SHHD4348-31
	SHHD5548-25
	SHHD5548-31

Design Considerations:

- The drawings show a Shaker hood with crown moldings attached.
- The crown molding is supplied loose and fitted on site.



louvered hood specifications



Detailed and Timeless.

The Louvered Hood by  NatureKast® combines the timeless appeal of the louvered door with the versatility of our various finishes.

- Sizes: 42 3/4"W & 54 3/4"W, 36"H, 42"H & 48" high, 24 3/8"D or 31"D
- This hood is built in three sections, with an internal plywood structural frame
- Stainless steel laminate liner can be cut on site to fit most hood inserts
- Available in all Cypress Paint, Stain & Glaze and Weathered finishes. Not currently available in Teak resin
- 100% weatherproof hood material can be used indoors or outdoors
- All hoods must be installed a minimum of 36" from the cooking surface. Check with local building codes and appliance specs
- Deeper hoods should be used over grill cabinets or any cooking appliance that is deeper than 24"

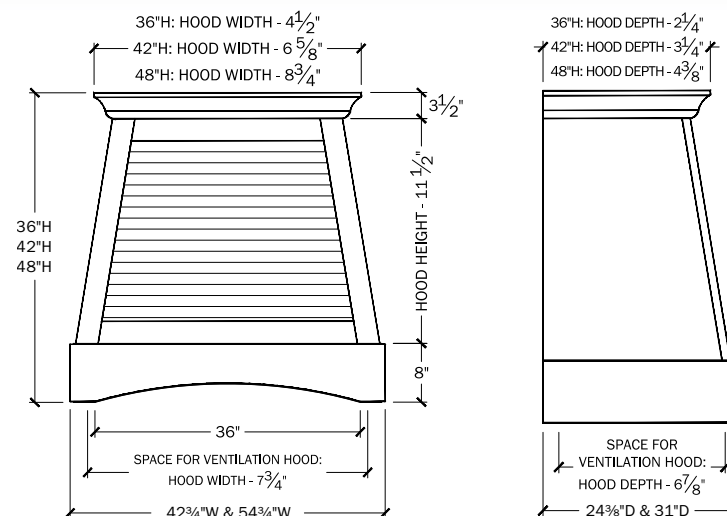

item-code	
36"H	LOHD4336-25
	LOHD4336-31
	LOHD5536-25
	LOHD5536-31
42"H	LOHD4342-25
	LOHD4342-31
	LOHD5542-25
	LOHD5542-31
48"H	LOHD4348-25
	LOHD4348-31
	LOHD5548-25
	LOHD5548-31



Design Considerations:

- The drawings show a Louver hood with crown moldings attached.
- The crown molding is supplied loose and fitted on site.

Species available:  CypressKast





panels, fillers
& pilasters



loose resin finished end panels

Wall Finished End – Loose



C T

item-code	species*
WFEL1218	C,T
WFEL1224	C,T
WFEL1230	C,T
WFEL1236	C,T
WFEL1242	C,T
WFEL1248	C,T
WFEL1254	C
WFEL1260	C

Base Finished End – Loose



C T

item-code	species*
BFEL2430	C,T
BFEL2830	C,T
BFEL3230	C,T
BFEL2436	C,T
BFEL2836	C,T
BFEL3236	C,T

Tall Finished End – Loose



C

item-code
TFEL1296
TFEL1896
TFEL2196
TFEL2496

Design Considerations:

- ¾" thick wall cabinet depth resin panel finished on face and 1 vertical edge
- Ships loose



Design & Installation: Cabinet Genies

3/4" thick resin panels

3/4" Thick Resin Panel



C T

item-code	species*
13"W	
FP1330	C,T
FP1336	C,T
FP1342	C,T
FP1396	C
FP13120	C

Design Considerations:

- 3/4" thick resin panel finished on face and 1 long edge



C T

item-code	species*
30"W	
FP3030	C,T
FP3036	C,T
FP3042	C
FP3096	C
FP30120	C
48"W	
FP4836	C,T
FP4842	C
60"W	
FP6036	C
FP6042	C

Design Considerations:

- 3/4" thick resin panel finished on face and 2 vertical edges

3/4" Resin Panel with V-Grooves



C T

item-code	species*
PCVG2430	C
PCVG2436	C
PCVG2442	C
PCVG3049	T
PCVG2496	C

Design Considerations:

- 3/4" thick with lap joints on long edges
- V-grooves spaced 6" from center to center
- Available in all Paint, Stain and Weathered finishes

pvc panels



Black & White PVC



item-code

PVC PANEL 2436
PVC PANEL 4836
PVC PANEL 396
PVC PANEL 696
PVC PANEL 1296
PVC PANEL 2496
PVC PANEL 3096
PVC PANEL 3696

Design Considerations:

- 3/4" thick PVC panel
- PVC color will match cabinet box construction
- Used as a structural component and MUST be covered with resin if exposed to direct sunlight
- For non-listed sizes, select the next largest panel and reduce down.



euro panel

1/2" Thick Phenolic Resin (HPL) Panel



E

item-code

EUROCUSTPNL

Design Considerations:

- 1/2" thick Euro panel at variable width and height
- Maximum width is 72" & maximum height is 42"
- Grain direction (where applicable) matches the direction of the grain in the room
- Finished on front and back with ebony edge
- Check catalog specifications for cutting and bonding Euro panel

metro panel

3/4" Thick HDPE Panel



M

item-code

HDPECUSTPNL

Design Considerations:

- 3/4" thick METRO panel at variable width and height
- Grain direction (where applicable) matches the direction of the grain in the room
- Finished on front and back with ebony edge
- Check catalog specifications for cutting and bonding Euro panel
- Maximum width is 72" & maximum height is 42" (grain, if applicable, is horizontal)

applied resin finished end panels

Wall Finished End – Applied



C T

item-code species*

WFEA1218L	C,T
WFEA1218R	C,T
WFEA1224L	C,T
WFEA1224R	C,T
WFEA1230L	C,T
WFEA1230R	C,T
WFEA1236L	C,T
WFEA1236R	C,T
WFEA1242L	C,T
WFEA1242R	C,T
WFEA1248L	C,T
WFEA1248R	C,T
WFEA1254L	C
WFEA1254R	C
WFEA1542L	C
WFEA1542R	C
WFEA1260L	C
WFEA1260R	C

Base Finished End – Applied



C T

item-code species*

BFEA2430L	C,T
BFEA2430R	C,T
BFEA2830L	C,T
BFEA2830R	C,T
BFEA3230L	C,T
BFEA3230R	C,T

Design Considerations:

- 3/4" thick cabinet depth resin panel finished on face and 1 long edge and applied to cabinet

applied euro finished end panels

Wall Finished End – Applied



E

item-code

WFEA1218EUROL
WFEA1218EUROR
WFEA1224EUROL
WFEA1224EUROR
WFEA1230EUROL
WFEA1230EUROR
WFEA1236EUROL
WFEA1236EUROR
WFEA1242EUROL
WFEA1242EUROR
WFEA1248EUROL
WFEA1248EUROR
WFEA1254EUROL
WFEA1254EUROR
WFEA1542EUROL
WFEA1542EUROR
WFEA1260EUROL
WFEA1260EUROR

Base Finished End – Applied



E

item-code

BFEA2430EUROL
BFEA2430EUROR
BFEA2830EUROL
BFEA2830EUROR
BFEA3230EUROL
BFEA3230EUROR

Design Considerations:

- ½" thick Euro panel applied to cabinet
- Panel is flush with door front extending the full depth of the cabinet

applied metro finished end panels



Wall Finished End – Applied



M

item-code

WFEA12.87518-.75L
WFEA12.87518-.75R
WFEA12.87524-.75L
WFEA12.87524-.75R
WFEA12.87530-.75L
WFEA12.87530-.75R
WFEA12.87536-.75L
WFEA12.87536-.75R
WFEA12.87542-.75L
WFEA12.87542-.75R
WFEA12.87548-.75L
WFEA12.87548-.75R
WFEA12.87554-.75L
WFEA12.87554-.75R
WFEA15.87542-.75L
WFEA15.87542-.75R
WFEA12.87560-.75L
WFEA12.87560-.75R

Base Finished End – Applied



M

item-code

BFEA24.87530-.75L
BFEA24.87530-.75R
BFEA28.87530-.75L
BFEA28.87530-.75R
BFEA32.87530-.75L
BFEA32.87530-.75R

Design Considerations:

- ¾" thick Metro panel applied to cabinet
- Panel is flush with door front extending the full depth of the cabinet



appliance panels

Appliance Doors



C T

item-code	species*
APPLPNL2430	C,T

Design Considerations:

- Available in custom sizes less than 24" W x 30" H
- Panels can be reduced in size at no additional cost
- 24"W x 30"H* is compatible with most under counter refrigerators
- 15"W x 30"H* is a common size for ice makers
- In most cases these standard sizes apply
- If panels are reduced, there will be a visible seam on the face
- Panels will match the door style listed in the header information
- For Euro and Metro appliance panels, please input exact size required in variable panel

* Please note that these are recommended sizes based on our experience with most appliances.
Please refer to your manufacturer's specifications for exact requirements as we cannot guarantee the fit of our standard sized panels for all applications.

decorative overlay doors

Deco Doors



C T

item-code	species*
DECODOOR930	C,T
DECODOOR1224	C,T
DECODOOR1230	C,T
DECODOOR13.530	C,T
DECODOOR1530	C,T
DECODOOR1236	C,T
DECODOOR16.530	C,T
DECODOOR1818	C,T
DECODOOR1536	C,T
DECODOOR1830	C,T
DECODOOR19.530	C,T
DECODOOR1836	C,T
DECODOOR2130	C,T
DECODOOR2430	C,T
DECODOOR2836	T
DECODOOR3036	T

Design Considerations:

- Resin decorative overlay doors have unfinished backs and are used in applications where they are attached to a rigid surface
- For Euro and Metro overlay doors, please input size in variable panel

faux brick panels



Dove White



item-code

PBRK4732-DW

Adobe Brown



item-code

PBRK4732-AB

Mountain Grey



item-code

PBRK4732-MG

Design Considerations:

- Interlocks with subsequent faux brick panels on all edges
- $\frac{3}{4}$ " thick where bricks interlock
- Total thickness = $\frac{3}{4}$ "
- Actual panel size: 47"W x 32"H
- There are no finished ends
- Fillers or posts are recommended to finish off edges
- Panels to be designed as insert panels

PRICING NOTE: Price now includes finish factors



stacked stone panels

Dove White



item-code

PSS4925-DW

Desert Sand



item-code

PSS4925-DS

Oxford Grey



item-code

PSS4925-OG

Design Considerations:

- Interlocks with subsequent stacked stone panels on all edges
- 3/4" thick where stones interlock
- Total thickness = 1 1/2"
- Actual panel size: 49"W x 24 3/4"H
- Interlock repeats 43 1/2"W x 24"H
- There are no finished ends
- Fillers or posts are recommended to finish off edges
- Panels to be designed as insert panels

PRICING NOTE: Price now includes finish factors

slab fillers



CypressKast Filler



Profile:



item-code

3"

F330

F336

F342

F396

F3108

7"

F730

F736

F742

F796

F7108

Design Considerations:

- [3" or 7"]W x ¾" thick resin filler finished on face and 2 long edges
- Total thickness = ¾"

CypressKast Filler with Backer



Profile:



item-code

3"

FB330

FB336

FB342

FB396

FB3108

7"

FB730

FB736

FB742

FB796

FB7108

Design Considerations:

- [3" or 7"]W x ¾" thick resin filler finished on face and 2 long edges
- ¾" thick PVC backer
- Total thickness = 1 ½"

TeakKast/Metro Filler



Profile:



item-code

3"

F330

F336

F342

F396

6"

F630

F636

F642

F696

Design Considerations:

- [3" or 6"]W x ¾" thick filler finished on face and 2 long edges
- Total thickness = ¾"

TeakKast/Metro Filler with Backer



Profile:



item-code

3"

FB330

FB336

FB342

FB396

6"

FB630

FB636

FB642

FB696

Design Considerations:

- [3" or 6"]W x ¾" thick filler finished on face and 2 long edges
- ¾" thick PVC backer
- Total thickness = 1 ½"

Species available: CypressKast TeakKast Euro Metro

* **Note:** Resin panels are NOT rigid and must be adhered to PVC cabinetry components using a **Polyurethane adhesive** like NP1 or PL Premium.

panels, fillers
& pilasters



door match fillers

Euro Filler with Backer

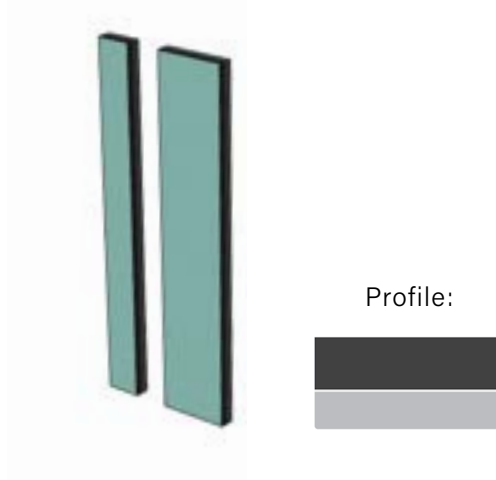

E

item-code

3"

DMFB318EURO

DMFB324EURO

DMFB330EURO

DMFB336EURO

DMFB342EURO

DMFB348EURO

DMFB354EURO

6"

DMFB618EURO

DMFB624EURO

DMFB630EURO

DMFB636EURO

Design Considerations:

- Overall dimensions: 3"W or 6"W x 1 1/2"D
- 2 7/8"W or 5 7/8"W x 1/2" thick Euro filler with 1/16" reveal all around
- Attached to a 3" W x 3/4" thick cabinet line matched PVC backer

Door Match Filler



Profile:

C

item-code

3"

DMF330

6"

DMF618

DMF624

DMF630

DMF636

DMF690

Design Considerations:

- [2 7/8" or 5 7/8"]W x 1" thick resin filler finished on face and all edges and includes door match edge detail all around

Door Match Filler with Backer



Profile:

C

item-code

3"

DMFB330

6"

DMFB618

DMFB624

DMFB630

DMFB636

DMFB690

Design Considerations:

- Overall dimensions: [3" or 6"]W x 1 3/4"D
- [2 7/8" or 5 7/8"]W x 1" thick resin filler finished on face and all edges and includes door match edge detail all around
- 3/4" thick PVC backer
- Total thickness = 1 3/4"

corner fillers



3"W Outside Corner Filler



Profile:



item-code

CF3336

CF3342

CF3396

Design Considerations:

- Overall dimensions: 3"W x 3"W x [36", 42" or 96"H]
- 3/4" thick resin fillers at 90° (inverted) finished on both 3"W outside faces and both long edges
- Especially useful for hiding corner joints on islands and peninsulas

3"W x 36"H Corner Filler



Profile:



item-code

FOL3336

Design Considerations:

- Overall dimensions: 10 3/4"W x 10 3/4"W x 36"H
- 3"W x 3"W x 3/4" thick resin fillers at 90° finished on all four faces
- 3/4" thick PVC backers

30"H Corner Filler



Profile:



item-code

3" x 3"

CFB3330

5" x 5"

CFB5530

Design Considerations:

- 3/4" thick fillers at 90° finished on both 3"W inside faces and both long edges
- 3/4" thick PVC backers
- Overall dimensions 3x3": 4 1/2"W x 4 1/2"D x 30"H
- Overall dimensions 5x5": 5 1/2"W x 6 1/2"D x 30"H

Euro 30"H Corner Filler



Profile:



item-code

3" x 3"

CFB3330EURO

5" x 5"

CFB5530EURO

Design Considerations:

- 1/2" thick Euro corner filler at 90° finished on both 3"W inside faces with ebony edge and 3/4" thick PVC backers
- Overall dimensions 3x3": 4 1/4"W x 4 1/4"D x 30"H
- Overall dimensions 5x5": 6 1/4"W x 6 1/4"D x 30"H

Species available: CypressKast TeakKast Euro Metro

* **Note:** Resin panels are NOT rigid and must be adhered to PVC cabinetry components using a **Polyurethane adhesive** like NP1 or PL Premium.

panels, fillers
& pilasters



resin base pilasters

Base Pilaster 'A'



Profile:



C T

item-code

BPA336-7

BPA336-13

BPA336-25

BPA336-29

BPA336-33

Design Considerations:

- 3"W x [7", 13", 25", 29" or 33"] D x 36"H
- Finished on 3"w face and both sides

Base Pilaster 'A' EXT



Profile:



* Extended PVC to support countertop between appliances.

C T

item-code

BPA336-7-PVC25X

BPA336-7-PVC29X

Design Considerations:

- 3"W x [25" or 29"] D x 36"H
- 7" resin return with PVC extension to support countertop between appliances
- Finished on 3"w face and both 7" resin return sides

Base Pilaster 'B'



Profile:



C T

item-code

BPB336-13

BPB336-25

BPB336-29

BPB336-33

Design Considerations:

- 3"W x [13", 25", 29" or 33"] D x 36"H
- Finished on 3"w face and two sides (including 7" resin return)

Base Pilaster 'B' Slim



Profile:



C T

item-code

BPB1.536-13

BPB1.536-25

BPB1.536-29

BPB1.536-33

Design Considerations:

- 1 1/2"W x [13", 25", 29" or 33"] D x 36"H
- Finished on two sides and one 7" resin return





Base Pilaster 'B' Slim (reinforced)



Profile:



C T

item-code

BPB-R1.536-13

BPB-R1.536-25

BPB-R1.536-29

BPB-R1.536-33

Design Considerations:

- 1 1/2"W x [13", 25", 29" or 33"]D x 36"H
- Finished on two sides and one 7" resin return
- Has **aluminum L-profile** for extra structural support when not secured to a cabinet

Base Pilaster 'C' (resin return)



Profile:



C T

item-code

BPC336-7 RSN

BPC336-13 RSN

BPC336-25 RSN

BPC336-29 RSN

BPC336-33 RSN

Design Considerations:

- 3"W x [7", 13", 25", 29" or 33"]D x 36"H
- Finished on 3"w face, side return and long inside edge

Base Pilaster 'C' (PVC return)



Profile:



C T

item-code

BPC336-7 PVC

BPC336-13 PVC

BPC336-25 PVC

BPC336-29 PVC

BPC336-33 PVC

Design Considerations:

- 3"W x [7", 13", 25", 29" or 33"]D x 36"H
- Finished on 3"w face and both long edges

Base Pilaster 'D'



Profile:



C T

item-code

BPD336-26

BPD336-30

BPD336-34

Design Considerations:

- 3"W x [26", 30" or 34"]D x 36"H
- Finished on both 3"w faces, side panel and both 7" resin returns



euro base pilasters

Base Pilaster 'A'



Profile:



E

item-code

BPA336-6.625-EURO
BPA336-12.625-EURO
BPA336-24.625-EURO
BPA336-28.625-EURO
BPA336-32.625-EURO

Design Considerations:

- 3"W x [6.625", 12.625", 24.625", 28.625" or 32.625"]D x 36"H
- Finished on 3"w face and both sides

Base Pilaster 'A' EXT

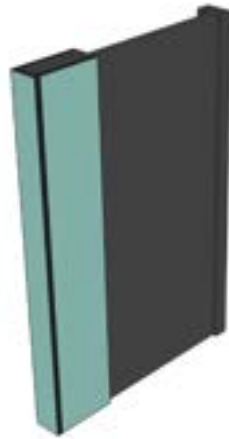

Profile:



* Extended PVC to support countertop between appliances.

E

item-code

BPA336-7-EUROPVC24.625X
BPA336-7-EUROPVC28.625X

Design Considerations:

- 3"W x [24.625" or 28.625"]D x 36"H
- 7" return with PVC extension to support countertop between appliances
- Finished on 3"w face and both 7" return sides

Base Pilaster 'B'



Profile:



E

item-code

BPB336-12.625-EURO
BPB336-24.625-EURO
BPB336-28.625-EURO
BPB336-32.625-EURO

Design Considerations:

- 3"W x [12.625", 24.625", 28.625" or 32.625"]D x 36"H
- Finished on 3"w face and two sides (including 7" return)





Base Pilaster 'C'

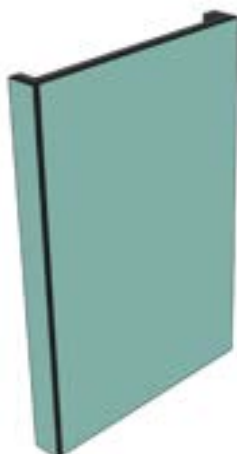

Profile:



E

item-code

BPC336-6.625-EURO
BPC336-12.625-EURO
BPC336-24.625-EURO
BPC336-28.625-EURO
BPC336-32.625-EURO

Design Considerations:

- 3"W x [6.625", 12.625", 24.625", 28.625" or 32.625"]D x 36"H
- Finished on 3"w face, side return and long inside edge

Base Pilaster 'C' (PVC return)



Profile:



E

item-code

BPC336-6.625-EURO PVC
BPC336-12.625-EURO PVC
BPC336-24.625-EURO PVC
BPC336-28.625-EURO PVC
BPC336-32.625-EURO PVC

Design Considerations:

- 3"W x [6.625", 12.625", 24.625", 28.625" or 32.625"]D x 36"H
- Finished on 3"w face and both long edges

Base Pilaster 'D'



Profile:



E

item-code

BPD336-25.375-EURO
BPD336-29.375-EURO
BPD336-33.375-EURO

Design Considerations:

- 3"W x [25.375", 29.375" or 33.375"]D x 36"H
- Finished on both 3"w faces, side panel and both 7" returns



metro base pilasters

Base Pilaster 'A'



Profile:



item-code

BPA336-6.875-0.75
BPA336-12.875-0.75
BPA336-24.875-0.75
BPA336-28.875-0.75
BPA336-32.875-0.75

Design Considerations:

- 3"W x [6.875", 12.875", 24.875", 28.875" or 32.875"]D x 36"H
- Finished on 3"w face and both sides

Base Pilaster 'A' EXT



Profile:



* Extended PVC to support countertop between appliances.



item-code

BPA336-7-0.75PVC24.875X
BPA336-7-0.75PVC28.875X

Design Considerations:

- 3"W x [24.875" or 28.875"]D x 36"H
- 7" return with PVC extension to support countertop between appliances
- Finished on 3"w face and both 7" return sides

Base Pilaster 'B'



Profile:



item-code

BPB336-12.875-0.75
BPB336-24.875-0.75
BPB336-28.875-0.75
BPB336-32.875-0.75

Design Considerations:

- 3"W x [12.875", 24.875", 28.875" or 32.875"]D x 36"H
- Finished on 3"w face and two sides (including 7" return)





Base Pilaster 'C'



Profile:



item-code

BPC336-6.875-0.75
BPC336-12.875-0.75
BPC336-24.875-0.75
BPC336-28.875-0.75
BPC336-32.875-0.75

Design Considerations:

- 3"W x [6.875", 12.875", 24.875", 28.875" or 32.875"]D x 36"H
- Finished on 3"w face, side return and long inside edge

Base Pilaster 'C' (PVC return)



Profile:



item-code

BPC336-6.875-0.75 PVC
BPC336-12.875-0.75 PVC
BPC336-24.875-0.75 PVC
BPC336-29.875-0.75 PVC
BPC336-32.875-0.75 PVC

Design Considerations:

- 3"W x [6.875", 12.875", 24.875", 28.875" or 32.875"]D x 36"H
- Finished on 3"w face and both long edges with PVC return

Base Pilaster 'D'



Profile:



item-code

BPD336-25.875-0.75
BPD336-29.875-0.75
BPD336-33.875-0.75

Design Considerations:

- 3"W x [25.875", 29.875" or 33.875"]D x 36"H
- Finished on both 3"w faces, side panel and both 7" returns



resin wall pilasters

Wall Pilaster 'A'



Profile:



C T

item-code	species*
WPA318-7	C,T
WPA318-13	C,T
WPA324-7	C,T
WPA324-13	C,T
WPA330-7	C,T
WPA330-13	C,T
WPA336-7	C,T
WPA336-13	C,T
WPA342-7	C,T
WPA342-13	C,T
WPA348-7	C,T
WPA348-13	C,T
WPA354-7	C
WPA354-13	C

Design Considerations:

- 3"W x [7" or 13"]D x [18", 24", 30", 36", 42", 48" or 54"]H
- Finished on 3"w face and both sides

Wall Pilaster 'B'



Profile:



C T

item-code	species*
WPB318-13	C,T
WPB324-13	C,T
WPB330-13	C,T
WPB336-13	C,T
WPB342-13	C,T
WPB348-13	C,T
WPB354-13	C

Design Considerations:

- 3"W x 13"D x [18", 24", 30", 36", 42", 48" or 54"]H
- Finished on 3"w face and two sides (including 7" resin return)

Wall Pilaster 'C' (resin return)



Profile:



C T

item-code	species*
WPC318-13 RSN	C,T
WPC324-13 RSN	C,T
WPC330-13 RSN	C,T
WPC336-13 RSN	C,T
WPC342-13 RSN	C,T
WPC348-13 RSN	C,T
WPC354-13 RSN	C

Design Considerations:

- 3"W x 13"D x [18", 24", 30", 36", 42", 48" or 54"]H
- Finished on 3"w face, side return and long inside edge

Wall Pilaster 'C' (PVC return)



Profile:



C T

item-code
WPC318-13 PVC
WPC324-13 PVC
WPC330-13 PVC
WPC336-13 PVC
WPC342-13 PVC
WPC348-13 PVC
WPC354-13 PVC

Design Considerations:

- 3"W x 13"D x [18", 24", 30", 36", 42", 48" or 54"]H
- Finished on 3"w face and both long edges

euro wall pilasters



Wall Pilaster 'A'



Profile:



E

item-code

WPA318-6.625-EURO
WPA318-12.625-EURO
WPA324-6.625-EURO
WPA324-12.625-EURO
WPA330-6.625-EURO
WPA330-12.625-EURO
WPA336-6.625-EURO
WPA336-12.625-EURO
WPA342-6.625-EURO
WPA342-12.625-EURO
WPA348-6.625-EURO
WPA348-12.625-EURO
WPA354-6.625-EURO
WPA354-12.625-EURO

Design Considerations:

- 3"W x [6.625" or 12.625"]D x [18", 24", 30", 36", 42", 48" or 54"]H
- Finished on 3"w face and both sides

Wall Pilaster 'B'



Profile:



E

item-code

WPB318-12.625-EURO
WPB324-12.625-EURO
WPB330-12.625-EURO
WPB336-12.625-EURO
WPB342-12.625-EURO
WPB348-12.625-EURO
WPB354-12.625-EURO

Design Considerations:

- 3"W x 12.625"D x [18", 24", 30", 36", 42", 48" or 54"]H
- Finished on 3"w face and two sides (including 7" return)

Wall Pilaster 'C'



Profile:



E

item-code

WPC318-12.625-EURO
WPC324-12.625-EURO
WPC330-12.625-EURO
WPC336-12.625-EURO
WPC342-12.625-EURO
WPC348-12.625-EURO
WPC354-12.625-EURO

Design Considerations:

- 3"W x 12.625"D x [18", 24", 30", 36", 42", 48" or 54"]H
- Finished on 3"w face, side return and long inside edge

Wall Pilaster 'C' (PVC return)



Profile:



E

item-code

WPC318-12.625-EURO PVC
WPC324-12.625-EURO PVC
WPC330-12.625-EURO PVC
WPC336-12.625-EURO PVC
WPC342-12.625-EURO PVC
WPC348-12.625-EURO PVC
WPC354-12.625-EURO PVC

Design Considerations:

- 3"W x 12.625"D x [18", 24", 30", 36", 42", 48" or 54"]H
- Finished on 3"w face and both long edges



metro wall pilasters

Wall Pilaster 'A'



Profile:



item-code

WPA318-6.875-0.75
WPA318-12.875-0.75
WPA324-6.875-0.75
WPA324-12.875-0.75
WPA330-6.875-0.75
WPA330-12.875-0.75
WPA336-6.875-0.75
WPA336-12.875-0.75
WPA342-6.875-0.75
WPA342-12.875-0.75
WPA348-6.875-0.75
WPA348-12.875-0.75
WPA354-6.875-0.75
WPA354-12.875-0.75

Design Considerations:

- 3"W x [6.875" or 12.875"]D x [18", 24", 30", 36", 42", 48" or 54"]H
- Finished on 3"w face and both sides

Wall Pilaster 'B'



Profile:



item-code

WPB318-12.875-0.75
WPB324-12.875-0.75
WPB330-12.875-0.75
WPB336-12.875-0.75
WPB342-12.875-0.75
WPB348-12.875-0.75
WPB354-12.875-0.75

Design Considerations:

- 3"W x 12.875"D x [18", 24", 30", 36", 42", 48" or 54"]H
- Finished on 3"w face and two sides (including 7" return)

Wall Pilaster 'C'



Profile:



item-code

WPC318-12.875-0.75
WPC324-12.875-0.75
WPC330-12.875-0.75
WPC336-12.875-0.75
WPC342-12.875-0.75
WPC348-12.875-0.75
WPC354-12.875-0.75

Design Considerations:

- 3"W x 12.875"D x [18", 24", 30", 36", 42", 48" or 54"]H
- Finished on 3"w face, side return and long inside edge

Wall Pilaster 'C' (PVC return)



Profile:

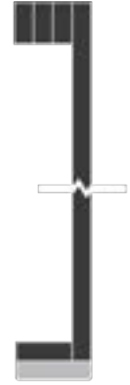

item-code

WPC318-12.875-0.75 PVC
WPC324-12.875-0.75 PVC
WPC330-12.875-0.75 PVC
WPC336-12.875-0.75 PVC
WPC342-12.875-0.75 PVC
WPC348-12.875-0.75 PVC
WPC354-12.875-0.75 PVC

Design Considerations:

- 3"W x 12.875"D x [18", 24", 30", 36", 42", 48" or 54"]H
- Finished on 3"w face and both long edges

resin tall pilasters



Tall Pilaster 'A'



Profile:



item-code

TPA396-7

TPA396-13

TPA396-25

Design Considerations:

- 3"W x [7", 13" or 25"]D x 96"H
- Finished on 3"w face and both sides

Tall Pilaster 'B'



Profile:



item-code

TPB396-13

TPB396-25

Design Considerations:

- 3"W x [13" or 25"]D x 96"H
- Finished on 3"w face and two sides (including 7" resin return)

Tall Pilaster 'C' (resin return)



Profile:



item-code

TPC396-13 RSN

TPC396-25 RSN

Design Considerations:

- 3"W x [13" or 25"]D x 96"H
- Finished on 3"w face, side return and long inside edge

Tall Pilaster 'C' (PVC return)



Profile:



item-code

TPC396-13 PVC

TPC396-25 PVC

Design Considerations:

- 3"W x [13" or 25"]D x 96"H
- Finished on 3"w face and both long edges



metro tall pilasters

Tall Pilaster 'A'



M

item-code

TPA396-6.875-0.75

TPA396-12.875-0.75

TPA396-24.875-0.75

Design Considerations:

- 3"W x [6.875", 12.875" or 24.875"]D x 96"H
- Finished on 3"w face and both sides

Tall Pilaster 'B'



M

item-code

TPB396-12.875-0.75

TPB396-24.875-0.75

Design Considerations:

- 3"W x [12.875" or 24.875"]D x 96"H
- Finished on 3"w face and two sides (including 7" return)

Tall Pilaster 'C' (resin return)



M

item-code

TPC396-12.875-0.75

TPC396-24.875-0.75

Design Considerations:

- 3"W x [12.875" or 24.875"]D x 96"H
- Finished on 3"w face, side return and long inside edge

Tall Pilaster 'C' (PVC return)

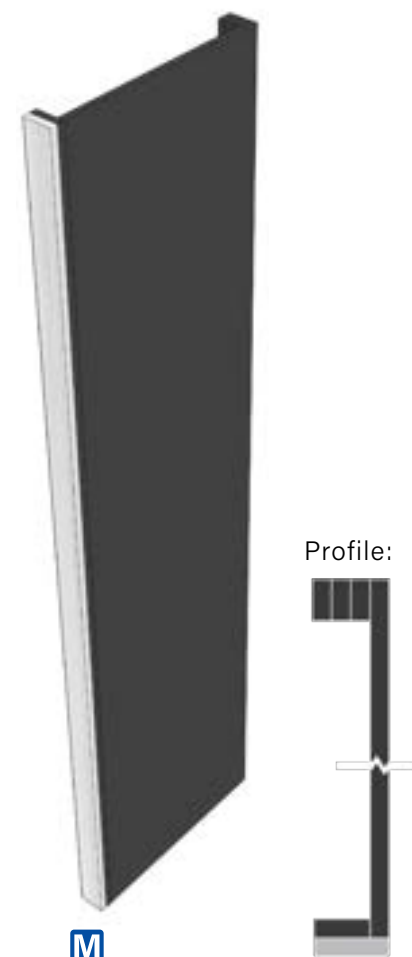

M

item-code

TPC396-12.875-0.75 PVC

TPC396-24.875-0.75 PVC

Design Considerations:

- 3"W x [12.875" or 24.875"]D x 96"H
- Finished on 3"w face and both long edges



raised counter walls



* Raised Bar Walls have been designed to allow easier installation of raised counter tops:

Raised Bar Wall

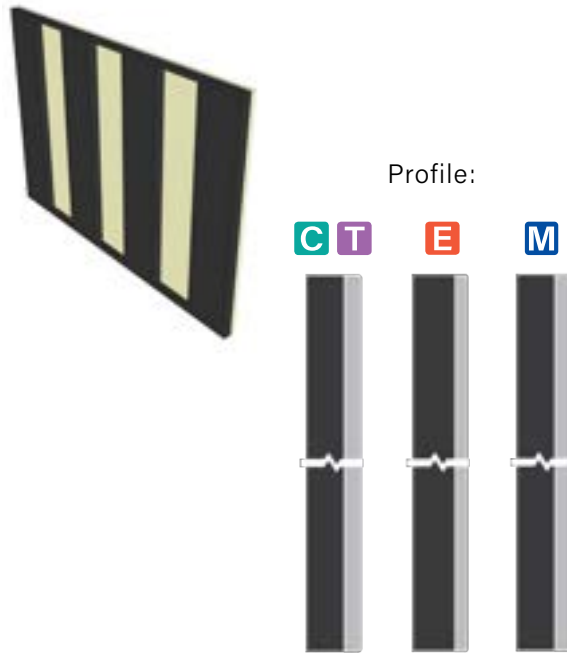

item-code	species*
RBW42	C,T,M
RBWVG42	C,T
RBW42-0.5	E

Design Considerations:

- 42"H (please specify lower if required)
- To be installed on back of base cabinets
- Price per linear inch of wall length
- Minimum length is 20"
- Maximum length is 60" but may be extended by using additional Raised Bar Walls
- These do not have End Caps and are to be used as internal wall pieces
- Wall is 2 1/4" thick
- Can be built with V-groove panels
- V-groove walls should be ordered 24" to retain lap-joint

Raised Bar Wall With End Cap

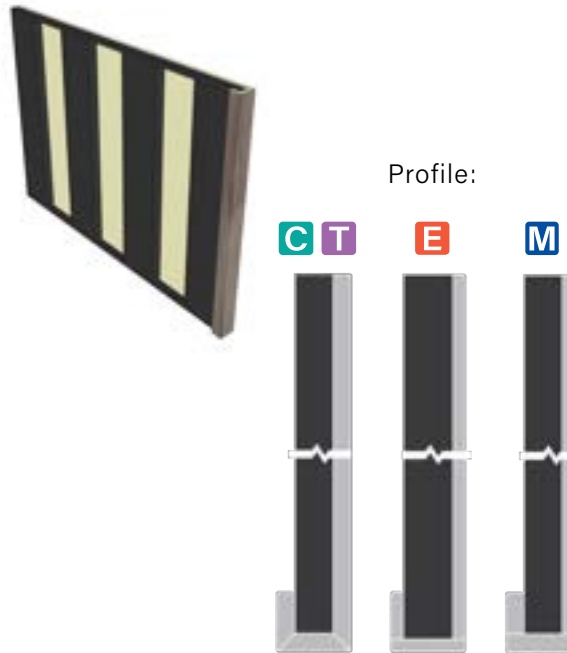

item-code	species*
RBWEC42	C,T,M
RBWECVG42	C,T
RBWEC42-0.5	E

Design Considerations:

- 42"H (please specify lower if required)
- To be installed on back of base cabinets
- Price per linear inch of wall length
- Minimum length is 20"
- Maximum length is 60" but may be extended by using additional Raised Bar Walls
- End cap is 3" wide with a 2" return
- Wall is 2 1/4" thick at the ribs
- Can be built with V-groove panels
- V-groove walls with end caps should be ordered 21"-23" to retain lap-joint

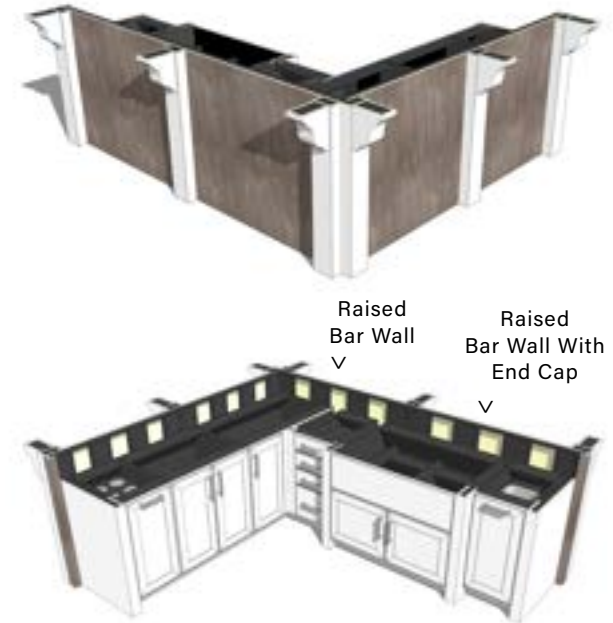

Features and considerations

- Raised bar walls need to be securely attached to the cabinets to provide a solid base for the counter tops
- Posts are used to cover the joints between the finished panels. Corbels can be attached to these to support the bar counter tops
- Backsplash should be attached above the base cabinets after counter has been installed
- End Cap Walls have a 2" return that will add to the length of the wall at the end of the cabinet run
- If designing an L-shaped configuration, allow 2 1/4" behind the cabinets when calculating the raised bar wall lengths needed

PRICING NOTE: Euro raised bar walls will also have the door factor applied

panels, fillers
& pilasters



Design & Installation: Ohana Outdoor Living



Design & Installation: Open Door Building Solutions



moldings





Design & Installation: Mauk Cabinets by Design

shelves

3"H Floating Shelf
with No Finished Ends



C **T**

item-code

FSH1224

FSH1230

FSH1236

Dimensions:

- 12"D x 3"H

Widths available:

- 24"W, 30"W & 36"W

Design Considerations:

- Unfinished ends
- PVC framework is installed on wall, then the resin cover slips over-top of PVC
- PVC frame is shipped loose inside resin cover
- Shelf is reinforced with an aluminum L-profile for additional strength
- Additionally shelf has concealed L-brackets to reduce shelf sag

3"H Floating Shelf
with Finished Ends



C **T**

item-code

FSHFE1224

FSHFE1230

FSHFE1236

Dimensions:

- 12"D x 3"H

Widths available:

- 24"W, 30"W & 36"W

Design Considerations:

- Finished ends
- PVC framework is installed on wall, then the resin cover slips over-top of PVC
- PVC frame is shipped loose inside resin cover
- Shelf is reinforced with an aluminum L-profile for additional strength
- Additionally shelf has concealed L-brackets to reduce shelf sag

Species available: **C** CypressKast **T** TeakKast **E** Euro **M** Metro

* **Note:** Panels are NOT rigid and must be adhered to PVC cabinetry components using a **Polyurethane adhesive** like NP1 or PL Premium.

moldings

123



posts

3-Sided Resin Posts



C T

item-code

PST3S-3336

PST3S-6330

PST3S-6336

PST3S-6342

PST3S-6354

PST3S-6396

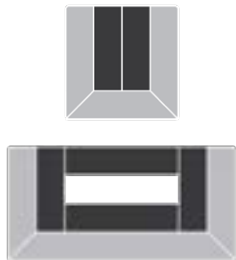

Design Considerations:

- Available in 3" or 6" W at 3"D
- Grain is vertical

4-Sided Resin Posts



C T

item-code

PST4S-3336

PST4S-3342

PST4S-6336

PST4S-6342

PST4S-6636

PST4S-6642

PST4S-6696

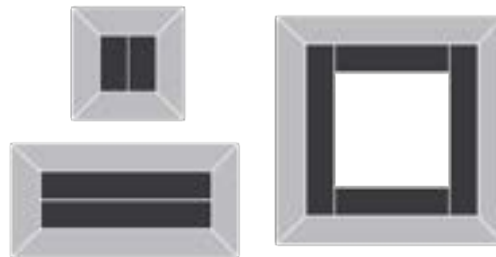

Design Considerations:

- Available in 3" and 6" widths
- Grain is vertical

3-Sided Euro Posts



E

item-code

PST3S-3336-EURO

PST3S-6330-EURO

PST3S-6336-EURO

PST3S-6342-EURO

PST3S-6354-EURO

PST3S-6396-EURO

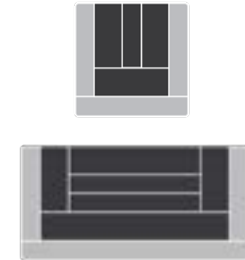

Design Considerations:

- Available in 3" or 6" W at 3"D
- Grain (if applicable) matches room
- Horizontal grain requires drawings



4-Sided Euro Posts



E

item-code

PST4S-3336-EURO
PST4S-3342-EURO
PST4S-6336-EURO
PST4S-6342-EURO
PST4S-6636-EURO
PST4S-6642-EURO
PST4S-6696-EURO

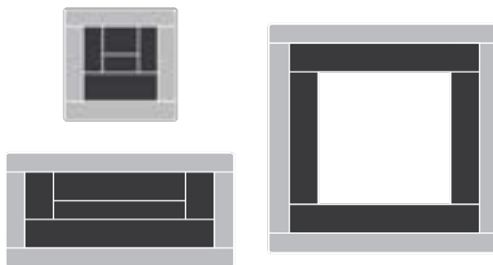

Design Considerations:

- Available in 3" and 6" widths
- Grain (if applicable) matches room
- Horizontal grain requires drawings

3-Sided Metro Posts



M

item-code

PST3S-3336
PST3S-6330
PST3S-6336
PST3S-6342
PST3S-6354
PST3S-6396

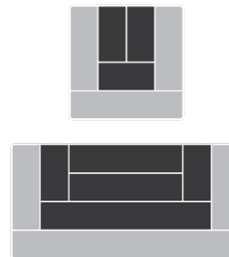

Design Considerations:

- Available in 3" or 6" W at 3"D
- Grain (if applicable) is vertical

4-Sided Metro Posts



M

item-code

PST4S-3336
PST4S-3342
PST4S-6336
PST4S-6342
PST4S-6636
PST4S-6642
PST4S-6696

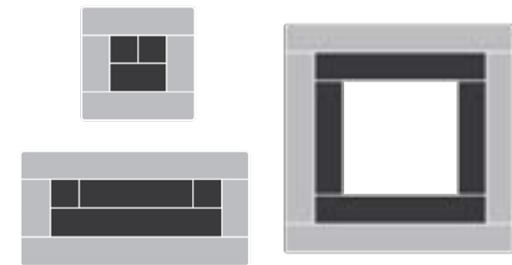

Design Considerations:

- Available in 3" and 6" widths
- Grain (if applicable) is vertical



brackets

Curled Bracket

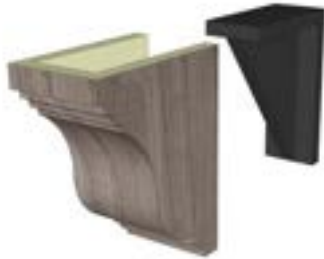

C T

item-code

Bracket C

Design Considerations:

- 8"D x 10"H x 5"W
- PVC support is mounted to the wall and decorative molded resin corbel slips over-top

Straight Bracket

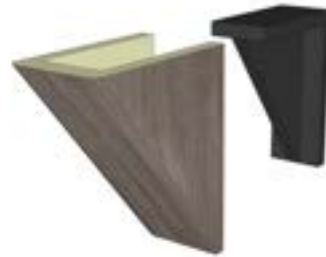

C

item-code

Bracket S

Design Considerations:

- 8"D x 10"H x 3"W
- Angled edges are profiled
- PVC support is mounted to the wall and fabricated resin corbel slips over-top

crown

Crown Molding



C

item-code

CRWN96

Design Considerations:

- 3 1/2"D x 3 1/2"H x 96"W
- Finished on the face only

Crown Molding
with Return



C

item-code

CRWNR96

Design Considerations:

- 3 1/2"D x 3 1/2"H x 96"W
- Return is PVC and is 1 3/4"D
- Finished on the face only
- The exposed bottom edge of the return will be covered with door matching edge tape

decorative moldings



Decorative Rail



item-code

DRM396

Design Considerations:

- 1"D x 3"H x 96"W
- Finished on the face and both long edges

Light Valance



item-code

LR396

Design Considerations:

Resin Rail:

- ¾"D x 3"H x 96"W
- Finished on the face and 2 long edges

Light Valance
with Aluminum Support



item-code

LRA396

Design Considerations:

Resin Rail:

- ¾"D x 3"H x 96"W
- Finished on the face and 2 long edges

Aluminum Backer:

- ¾"D x ¾"H x 96"W

This item is **REQUIRED** for the following cabinets:

- TVBF2 - WM (all sizes)

Light Valance
with PVC Backer



item-code

LRPVC396

Design Considerations:

Resin Rail:

- ¾"D x 3"H x 96"W
- Finished on the face and 2 long edges

90° PVC Backer:

- 2"D x 2"H x 96"W



Decorative Shoe



item-code

DSM196

Design Considerations:

- 1"D x 1"H x 96"W
- Finished on the face and 1 long edge

Insert Frame Molding



item-code

IFM96

Dimensions:

- 1 3/8" x 2" x 3/4"TH x 96"L
- Made of Resin
- Finished on 3 sides
- Order to trim around suspended cabinets that are used as insert cabinets

planks

Ship Lap V-Groove Plank



item-code

CP36

CP42

CP96

CP120

Dimensions:

- 3/4"D x 6"H

Widths available:

- 36"W, 42"W, 96"W & 120"W

Design Considerations:

- Can be used for complete ceiling or wall applications to match outdoor cabinetry
- Finished on the face and 2 long edges
- Can be used to cover tight radius structure applications

furniture bases

6"H Furniture Base



C

item-code

FBM696

Design Considerations:

- ½"D x 6"H x 96"W
- Manufactured at 6"H to allow for scribing to match rain pitch of deck
- Finished on the face and 1 long edge

6"H Furniture Base with Return



C

item-code

FBMR696

Design Considerations:

- 2 ¼"D x 6"H x 96"W
- Manufactured at 6"H to allow for scribing to match rain pitch of deck
- Finished on the face and 1 long edge

toe kick

CypressKast /Metro Toe Kick



C M

item-code species*

NK596 C,M

NK5108 C

NK796 C,M

NK7108 C

CypressKast Design Considerations:

- ¾"D x 5"H or 7"H x 96" or 108"W
- Finished on the face and 2 long edges

Metro Design Considerations:

- ¾"D x 5"H or 7"H x 96"W
- Finished on both sides with colour-match core
- For information on bonding Metro toe kick to PVC, see page 28

TeakKast Toe Kick



T

item-code

NK696

Design Considerations:

- ¾"D x 6"H x 96"W
- Finished on the face and 2 long edges





Euro Toe Kick with Vertical Grain



E

item-code

NK672EURO-V

Design Considerations:

- ½"D x 6"H x 72"W
- Grain direction is vertical
- Finished on front and back with ebony edge
- Only available for Wood Decors
- For information on bonding Euro toe kick to PVC, see page 27

Standard Euro Toe Kick (Horizontal Grain)



E

item-code

NK696EURO-H

Design Considerations:

- ½"D x 6"H x 96"W
- Finished on front and back with ebony colored edge
- For information on bonding Euro toe kick to PVC, see page 27

PVC Toe Kick



item-code

NK796PVC

Design Considerations:

- ¾"D x 7"H x 96"W
- Cabinet line matched PVC
- Used as a structural component and **MUST** be covered with resin if exposed to direct sunlight



accessories
& hardware



accessories

Touch Up Kit



item-code

TOUCH UP KIT

- Touchup kit for resin cabinetry
- Contains formulation specific to finish selected (painted, stain & glaze or weathered finish)
- Has appropriate FilStick to match base colour

Camlock for Door/Drawer



item-code

CAMLOCK

- Stainless steel camlock for doors or drawers
- Priced per lock
- Elbow latch is required on cabinets with 2 doors
- Each keyed differently

Elbow Latch



item-code

ELBOW LATCH

- Stainless steel elbow latch
- Priced per latch
- Installed on top of base cabinet doors and bottom of wall cabinet doors

Sealed Magnetic Catch



item-code

MAGNETIC CATCH

- Sealed catch for doors and drawers
- Set includes magnet and stainless steel plate
- Available in black or white to match cabinet box



NK Drill-in Push



item-code

NKPUSH

- Allows for spring-loaded opening of doors and drawers without handles
- Only works with motion hinges and soft-close drawer slides
- Concealed in cabinet gable or stretcher
- Adjustable standoff
- Available in black or white to match cabinet box

Slide-Out Trays



item-code

SOT9

SOT10.5

SOT12

SOT13.5

SOT15

SOT16.5

SOT18

SOT19.5

SOT21

SOT24

SOT27

SOT30

SOT33

SOT36

item-code

SOT9-8in

SOT10.5-8in

SOT12-8in

SOT13.5-8in

SOT15-8in

SOT16.5-8in

SOT18-8in

SOT19.5-8in

SOT21-8in

SOT24-8in

SOT27-8in

SOT30-8in

SOT33-8in

SOT36-8in

- The item-code correlates to the size of the base cabinet, not the overall slide out tray width
- 4"H or 8"H PVC slide out tray with a scoop detail on the front
- Installed into cabinet with 100% stainless steel full extension soft-close glides
- Front, sides and back panels are 1/2" thick, floor is 3/4" thick.

Weather Seal Gasket

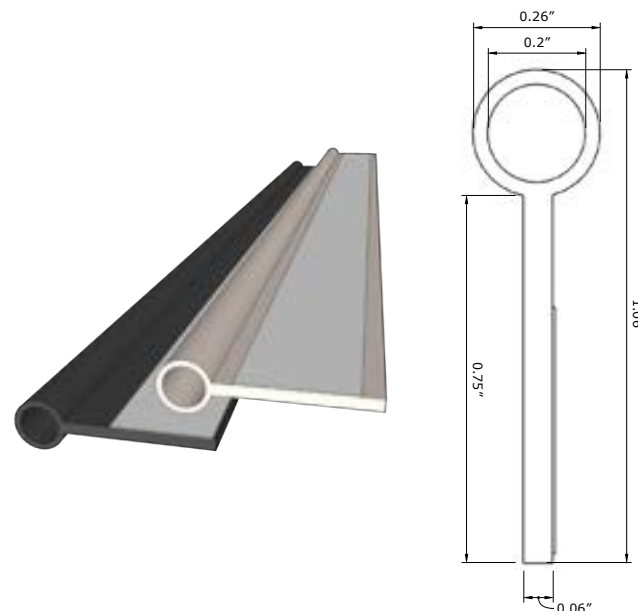

user-code

WSGASKET

WSGASKETWH

- 60 Duro EPDM weather seal with pressure sensitive adhesive
- Can be applied to drawer and door cabinets
- Use mechanical fasteners like staples to improve seal integrity
- When installed, bulb compresses to ± 0.125 ", so drawer tracks will need to be adjusted $\frac{1}{8}$ " back to compensate for this (not necessary for Contempo/Euro as doors/drawers are set up for $\frac{1}{8}$ " bumpers already)
- Door hinges may also require a minor adjustment
- Available in black or white



Adjustable Counter Bracket

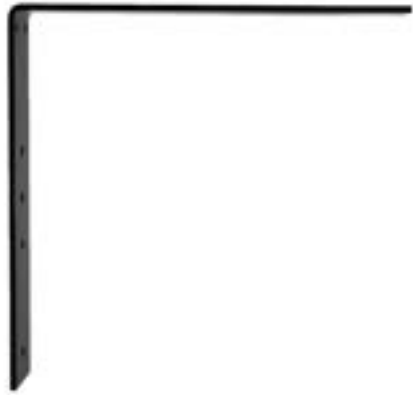

item-code

BRKT8"

BRKT10"

BRKT12"

Installation Kit and Requirements

Hardware Included:

- A - Floating Surface Adjustable Bracket (1)
- B - Allen head set screws (2)
- C - Phillips head wood screws (2)
- D - Allen wrench (1)

Tools Required:

- Phillips screw driver
- 1/8" drill bit
- Caulk
- Router
- Wood chisel

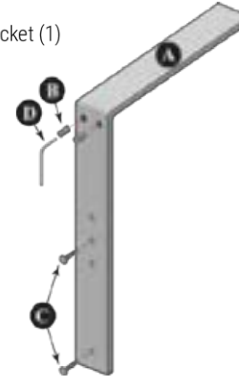

Bracket Installation Requirements:

- Wall thickness between 3/4" - 4" (add material if < 3/4")
- Must be placed directly under seams in countertop
- Used for overhangs between 8" and 18"

- Designed to allow easier installation of floating surfaces
- Full installation instructions included with product
- Includes required fasteners
- Manufactured by Steel Design Solutions using American-made structural steel (1/4" thick)
- Powder coated to guard against corrosion. Can safely be used outdoors without the threat of rust as long as the powder coating is not damaged
- Warranty covered by a limited 12 Month Manufacturers Warranty
- The bracket size is determined by the wall thickness and overhang length. See Table below:

OVERHANG LENGTH

WALL THICKNESS	8"	9"	10"	11"	12"	13"	14"	15"	16"
3/4"	8"	8"	8"	10"	10"	10"	12"	12"	12"
3"	10"	10"	10"	12"	12"	12"			

- Generally, you will need one bracket every 12-18". As a rule-of-thumb, use 2 brackets for 24-28", 3 brackets for 29-48", 4 brackets for 49-68", 5 brackets for 69-88" and 6 brackets for 89-108"



hardware



316 Stainless Steel Radius Pull



item-code

XL-JSR135TT

- Contemporary 5 1/4" stainless steel pull with ultimate corrosion resistance
- Screws included

304 Stainless Steel Low Profile Pull

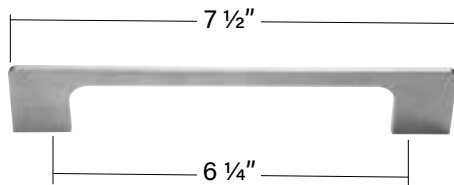

item-code

DSI-110-160

- Sleek contemporary 7 1/2" stainless steel low profile pull handle
- Screws included

304 Stainless Steel Square Pull

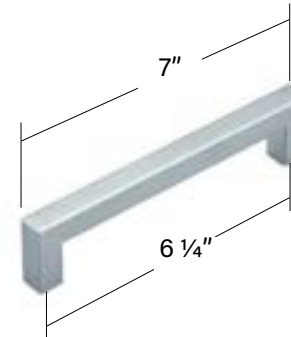

item-code

KPH-160

- Contemporary 7" stainless steel square pull handle
- Screws included

304 Stainless Steel Oval T Bar

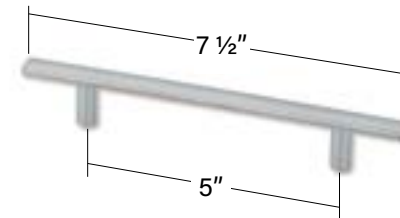

item-code

7014

- Contemporary 7 1/2" stainless steel oval pull handle
- Brushed finish
- Screws included

* No hardware sold separately.





Design & Installation: Deck Remodelers



modifications



structural modifications

Depth Adjustment



* Custom width and height modifications NOT available.

INCREASE DEPTH

item-code	up-charge
DEPTH INCREASE	20%

- Max depth = 32"D.
- Max TV cabinet depth = 12"D
- Drawer box depths do not change if depth of cabinet is increased

DECREASE DEPTH

item-code	up-charge
DEPTH DECREASE	0%

- Minimum depth with drawers = 12"D
- Minimum depth without drawers but with doors = 5"D

Cabinet Front Only



item-code	up-charge
CAB FRNT ONLY	20%

- PVC frame is 4"D (to allow for hinges)
- Black PVC cannot be exposed to direct sunlight
- Not available for cabinets with drawers

Add Vent to Cabinet



item-code
ADD VENT

- Adds a vent to the floor of a base cabinet

Add a Drawer Partition



item-code
DRAWER DIVIDER

- Inserts a ½" thick cabinet-line match PVC front-to-back partition into the drawer box
- Partition(s) will be evenly spaced within the drawer
- Priced per partition



Picture: Jeffrey A. Davis Photography, Inc



sales
resources



printed sales resources

Package NatureKast Brochures



item-code

BROCHURES 25

BROCHURES 50

- Tri-fold to 11" x 8 ½"
- Litho print on heavy stock with soft-touch AQ
- Luxurious brochure for showrooms and maximum impact opportunities

Package NatureKast Leaflets



item-code

LEAFLETS 50

LEAFLETS PKG 100

- Tri-fold letter size to 6"W x 6"H
- Litho print on heavy stock with soft-touch AQ
- Great for show hand-outs and maildrops

NatureKast Catalog 2019



item-code

NATUREKAST CATALOG 2020

- 152 full-color pages
- Letter size to 11"W x 8 ½"H
- Litho print with soft-touch AQ cover

sample resources



Colour Block Set with Contempo Door



item-code

COLOUR BLOCK SET

Included in Kit:

- Set of 23 samples
- Four 12" x 12" half Louver doors with the Weathered finishes
- One 12" x 12" Contempo door with aluminum rail
- Ten CypressKast color 3" x 6" blocks:
 - Two painted blocks
 - Six Stain & Glaze blocks
 - Two Weathered Finish blocks
- Five new TeakKast Color blocks (3" x 6" on a chain)
- Three Contempo frame samples (2" x 4" on a chain)
- Please check DealerNet for latest sample kit available

Euro Sample Set with Stand



item-code

EURO SAMPLE SET

Included in Set:

- One 8" x 8" Wood Decor sample door
 - 1/2" thick and finished both sides with characteristic ebony edge and 1/32" micro-chamfer
- Four 3 1/2" x 3 1/2" Wood Decor finish samples finished front side only
- Four 3 1/2" x 3 1/2" Pure Accent finish samples finished front side only
- Branded table display stand

Other considerations:

- Euro is an exclusive line, so please contact your rep if need more information or wish to carry this line

Metro Sample Set



item-code

METRO SAMPLE SET

- Set of ten sample HDPE blocks
- 5 3/4"W x 5 3/4"H

Colour Block set includes:

- Five lowsheen wood grain HDPE blocks
- Five solid colours



showroom for the road

Four Sample Doors



item-code

4 DOOR SAMPLE SET

- Set of four sample doors
- 12"W x 24"H

Door set includes:

- Louver door (Weathered Dockside)
- Shaker door (Espresso)
- Slab door (Raven Ash)
- Contempo door (Arctic Slate with matte black aluminum rail)

Suitcase Door & Drawer Cabinet



item-code

SUITCASE DISPLAY

Design Considerations:

- Effective as a take-anywhere showroom
- Cabinet box is 15"W x 6"H x 18"D
- Black PVC box with adjustable leg levelers
- Weathered Graphite drawer front
- Louver Door on top of cabinet
- Weathered Graphite finished end panel on 1 Side

Mini Base Door & Drawer Cabinet



item-code

MINI BASE CAB

Design Considerations:

- Effective as a take-anywhere showroom
 - Cabinet box is 15"W x 24"H x 14"D
 - Black PVC box with adjustable leg levelers
 - Weathered Graphite Drawer Front & Louver Door
 - Weathered Graphite finished end panels
 - Includes handles
- Shelves
- 1 adjustable shelf



outside
the box



a game-changer...

The Ultimate Outdoor Game Cabinet:
Introduced at KBIS & HPBA 2019

 NatureKast® Weatherproof Cabinetry transforms your backyard into an extension of the home. Our cabinets offer the functionality and allure of a high-end custom indoor kitchen, while withstanding any weather thrown at it. Now, we present The Ultimate Outdoor Game Cabinet series.

Tired of seeing the kids on their devices all the time? Put our latest cabinet outside and score a bulls-eye with your family and friends. Make your backyard THE place to hangout. At just over 8' tall, this first-of-its-kind cabinet is full of fun and games. Enjoy Darts, the addictive Mōlkky, bone-crushing Kubb and Kan Jam, all aesthetically integrated so that each game is ready for hours of outdoor fun. If you have the space and want to expand the gaming experience – get its twin and add other action-packed lawn games like Croquet, Boules, Bocce ball plus others.

If you don't have the space for a tall games cabinet, our Ultimate Outdoor Dartboard Cabinet features the deluxe upper portion of the Ultimate Games Cabinet "A" and has been designed especially for dart enthusiasts.

Game on!



2019 WINNER



the ultimate outdoor games cabinets



the ultimate outdoor games cabinet "a"



C T E M

GAMES INCLUDED

item-code

TUOGCA3694.5-16

Design Considerations:

- This cabinet consists of
2 - 36"H doors
2 - 24"H doors
2 - 30"H doors
- The 2 upper doors are pinned together (can be single door in Contempo, Euro or Metro)
- 6 adjustable legs for increased support
- Upper section has a foam-lined cavity with dartboard, scoreboard, dart caddy, lighting ring, slide out tray with two sets of darts and dart accessories. Lower section has slide-outs purpose-built for Kan Jam, Mölkky and Kubb

Partitions:

- The lower section will have a centered interior partition

the ultimate outdoor games cabinet "b"



C T E M

GAMES INCLUDED

item-code

TUOGCB3694.5-16

Design Considerations:

- This cabinet consists of
2 - 36"H doors
2 - 24"H doors
2 - 30"H doors
- The 2 upper doors are pinned together (can be single door in Contempo, Euro or Metro)
- 6 adjustable legs for increased support
- Upper section has a central open space with fixed shelf for Corn Hole Toss (bags and decks). Above this there is a centered partition with an adjustable shelf for Football, Baseball & Mitt, a fixed shelf for Washer Toss, a notched shelf for Croquet Sticks, a caddy for Croquet balls and pegs. Lower Section has convenient storage for Boules, Bocce and brackets for Luxury Horseshoe Set

Partitions:

- The lower and upper sections will have a centered interior partitions

the ultimate outdoor dartboard cabinet



C T E M

GAMES INCLUDED

item-code

TUODC3642-12

Design Considerations:

- This cabinet consists of
2 - 18"H doors
2 - 24"H doors
- The doors are pinned together or can be ordered as a single 42"H door in Contempo, Euro or Metro
- Has a foam-lined cavity with dartboard, scoreboard, dart caddy and lighting ring
- Slide out tray (with dividers) containing two sets of darts and dart accessories
- Cabinet is 12"D and has unfinished sides, top and bottom



outside
the box



an elegant solution

A Custom Mobile Bussing Cart

A NatureKast dealer in Oshawa, Ontario approached us to design and build a custom mobile bussing cart for an exclusive Golf Course. This was the result of that project.



blurring the lines between outdoors and indoors

In 2018 we were part of a joint project by National Association of > Home Builders (NAHB) & the International Builders Show (IBS). It featured an outdoor cooking area with two grills and two burner cabinets, needing an oversized custom contemporary hood



For most, the garage is just a room to store clutter (and possibly their car, if it fits). Claim yours back with our cabinetry



This design had ample elegant garage cabinetry along with a dog wash station making the washing and drying process significantly less messy



Pictures Jefferey A. Davis Photography



a natural (r)evolution

We continue striving to perfect the art of outdoor living

This project was a revolutionary. We were approached by one of our dealers in California to design a cabinet specifically for the Evo cooktop. It featured an open shelf to store the sizable lid when not in use. This cabinet inspired four other cabinets that we have added to our catalog, each built around different aspects and features of the Evo. Each one addresses specific practical or aesthetic attributes. We love being pushed to solve these sorts of design challenges and how they inspire new products and keep moving us forward.

Evo cooktops have been compatible with our cabinetry since we first heard about them.



Picture: Designs Living, Pirch



Picture: Designs Living, Pirch

custom TV cabinet hoods

Simply sensational

More than just a glorified chimney, these custom hoods really make a statement. Hoods with built-in TV cabinets are a thing, so why not get in on this trend. Our wide range of panels and moldings make hoods like these possible. Guaranteed to evoke the wow factor!



Picture: DreamMaker Bath & Kitchen





© August 2020, All Rights Reserved.

Copyright belongs to NatureKast, our Dealers and Photographers. All unlawful reproduction in whole or in part of this catalog is strictly prohibited without express written consent from NatureKast. Specifications are subject to change without notice. Print colours may vary from actual samples.